

State of S<sup>c</sup> Carolina Pursuant to a warrant from John Thomas  
 Com<sup>r</sup> of loc<sup>l</sup> & N<sup>o</sup> side Saluda dated 9<sup>th</sup> Nov<sup>r</sup> 1798 I have admeas<sup>d</sup>  
 and laid out unto Thomas Nicholas a tract of one hundred and  
 seventy two acres of land, on a branch of Childers second course  
 and other branches, all of South Tyger River in Greenville  
 County, bounded by lines running E & S<sup>e</sup> by land  
 survey for William Grant N<sup>o</sup> by  
 land unknown NW by land survey  
 for Abraham Chastain, SW by  
 NW by land survey for John  
 Postman, and hath such  
 shape and marks as the  
 above plat represents.  
 Survey 16<sup>th</sup> Nov<sup>r</sup> 1798,  
 W<sup>m</sup> D. Thomas D<sup>y</sup>  
 Recorded 17<sup>th</sup> Nov<sup>r</sup> 1798.

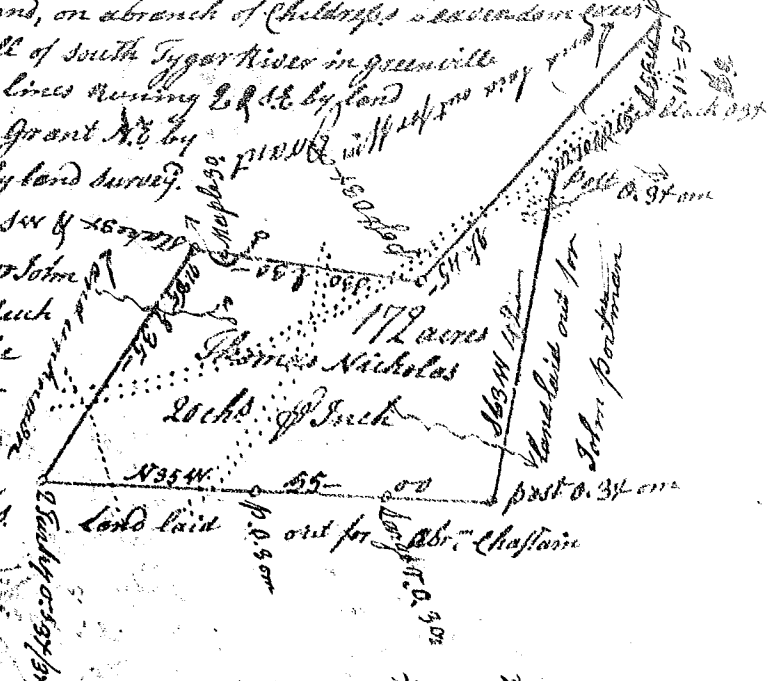

North Carolina Pursuant to a warrant from John  
 Thomas Esq<sup>r</sup> Com<sup>r</sup> of loc<sup>l</sup> & S<sup>e</sup> side Saluda, dated  
 17<sup>th</sup> Sept<sup>r</sup> 1798, I have admeasured and  
 laid out unto Abraham Chastain a tract  
 of two hundred acres of land, on branches  
 of South Tyger River in Greenville County  
 bounded by lines running NW & S by  
 Abr<sup>m</sup> Chastain land SE by land survey  
 for Thomas Nicholas N<sup>e</sup> N<sup>W</sup> by land  
 unknown NE by Duncan Wilkinson  
 land, and hath such shape & marks  
 as the above plat represents.  
 Survey 9<sup>th</sup> Nov<sup>r</sup> 1798,  
 Recorded 17<sup>th</sup> Nov<sup>r</sup> 1798.

