

State of S^c Carolina,

1798

Pursuant to a warrant from John Thomas,

Court of loc^ts dated 23rd Aug^t 1798, at have advised and laid out unto

George Woolf a tract of Two hundred and seven^{teen} acres of land in

Greenville County on both sides of branch of Barnes's branch of Middle fork of Saluda, bounded N^e by land laid out for George Woolf, John Barrow, & John Gowin, N^w by vacant land S^w by land laid out for Thomas Brummett, S^e by land laid out for Daniel McJunkin, and hath such shape & marks as the above plat represents.
Recorded 31st Oct^r 1798. Survey^d 24th Aug^t 1798. George Salmon D^r.

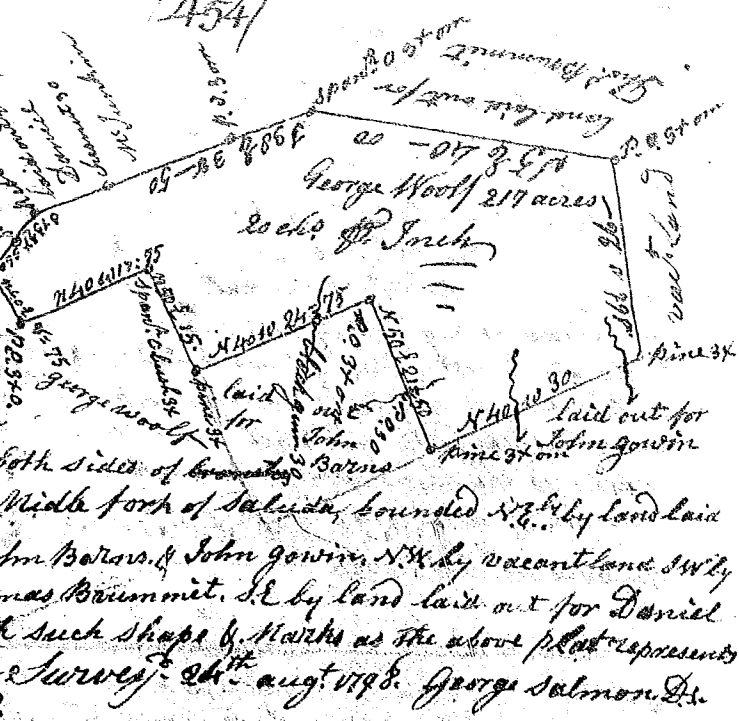

State of S^c Carolina Pursuant to a warrant from

John Thomas loc^t Court of loc^ts dated 24th Aug^t 1798, I have advised and laid out unto Joseph Dennis a tract of Two hundred & thirty acres of land, in Greenville County on the branches of the South & Middle forks of Saluda river, Bounded S^e by land laid out for Thomas Brummett & George Woolf N^e by land laid out for John Gowin N^w by land laid out for William Gilligan & vacant land S^w by land laid out for Elihu Hall Bay top and hath such shape & marks as the above plat represents,
Recorded 31st Oct^r 1798. Survey^d 24th Aug^t 1798. George Salmon D^r.

