

So Carolina

Pursuant to a Warrant from John Thomas Esq. of the N^o side of Broad river bearing date the 13th October 1798, I have surveyed for Jesse Tate a tract of one hundred & sixty four acres of land lying partly in Spartanburg County & partly in Union County, on the West side of Broad river including the mouth of Cherokee creek, bounded



Spartanburg County

On the North by said Tate's Land, On the East by the River & Lakes Land, On the South by west by State's Land of both sides of marks as the above plat represents Survey 15th Oct. 1798

Recorded 20th October 1798 De. J. Smith Esq.

Coopers Land

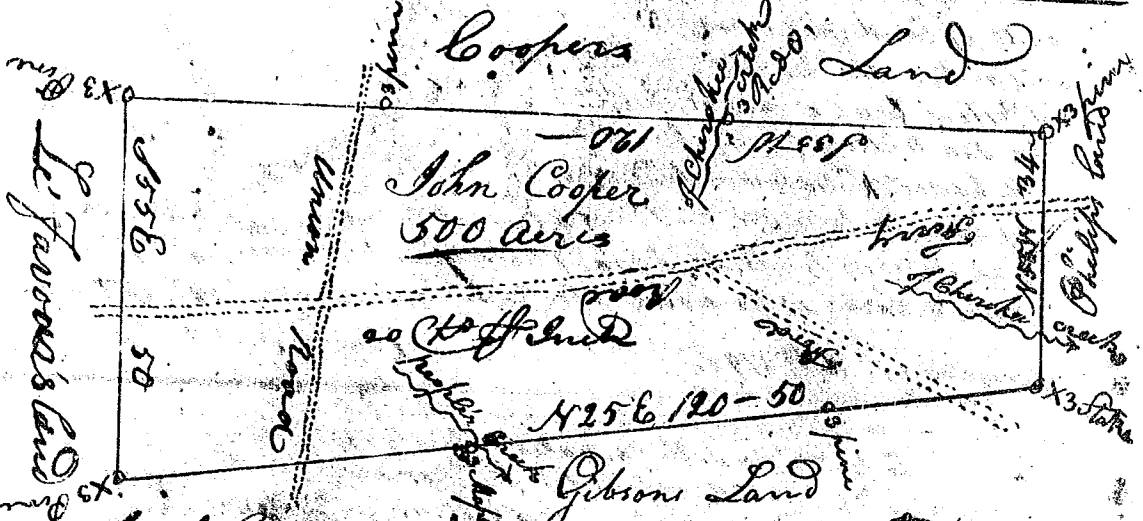

South Carolina Pursuant to a warrant from John Thomas Esq. of the N^o side of Broad river dated 4th Oct. 1798 I have surveyed for John Cooper a tract of 500 acres lying in the County of Spartanburg, on the waters of Cherokee, & Peoples Creeks, branches of Broad river, bounded on the N.W. by John Cooper's land, on the N.E. by Phillips Land & by Gibson's land & on the S.W. by land belonging to Le Favours, & both sides of marks, according to the above plat represents Survey the 19th Oct. 1798

Recorded the 20th Oct. 1798 De. J. Smith Esq.