

S. Carolina

Warrant to letters

from Wm. Thomas Esq. to

W. Talbot dated the 10th

Jan^y 1798. I have a piece

of land out onto John

Sanders a tract of 500

acres of land situated

the head branch of Mor-

gan's creek of Parce

river in Greenwell

County bounded by lines

W. by S. by S. by S. by

Henry Simons

East by Henry

Cooke, N.W. by N. by

George Sanders

N.E. by E. by John

Watson's N.W. by

W. D. Thomas's land, S.E. by

Abraham Carnegy of N. by

Pharmacian Mitchell's

lands & north each being 4

marks in the above plat represents

Survey'd the 11th Jan^y 1798

by Wm. D. Thomas Esq.

Recorded the 15th Feb^y 1798

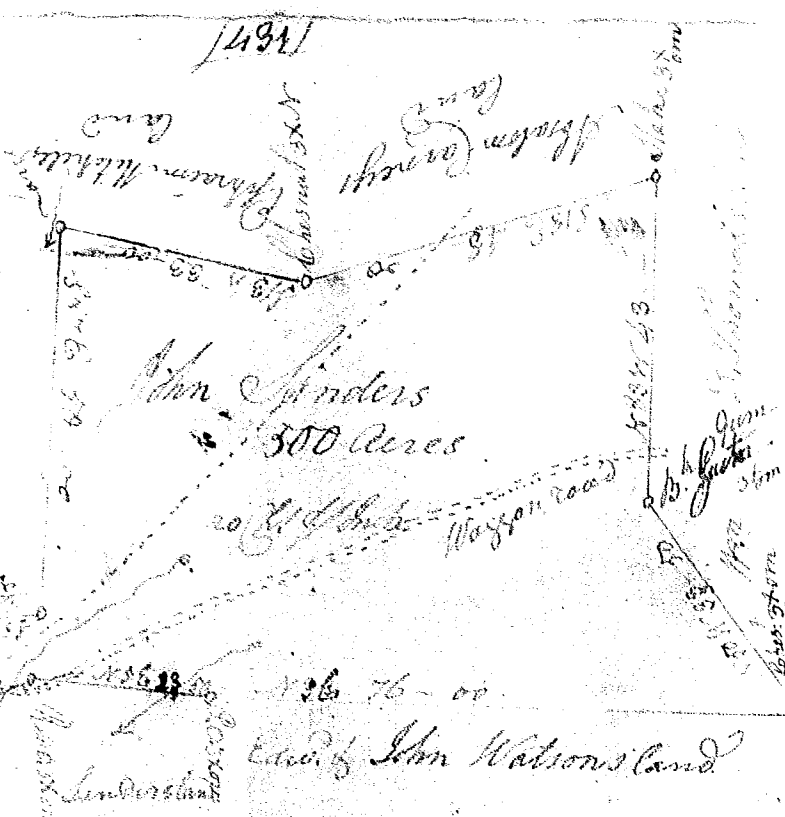

1798

Pharmacian Mitchell

Henry Simons

George Sanders

W.D. Thomas's land

John Sanders 500 Acres

Wagon Road

Wm. D. Thomas Esq.

Recorded the 15th Feb 1798