

4191

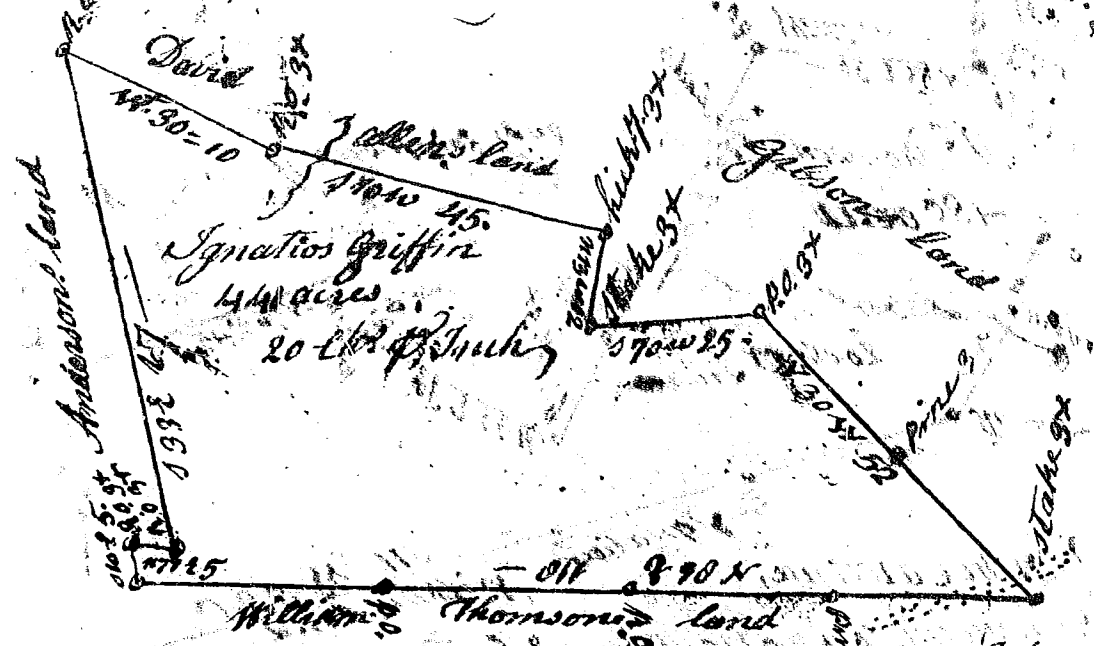

State of S^c Carolina Pursuant to a warrant from John
 Thomas Com^r of loc^y N^o Saluda I have admeasured
 and laid out unto Ignatius Griffin a tract of 4 1/2 acres
 of land in Pickney District Spartanburg County on bran-
 ches of Pickety Creek bounded N by Thomson's land S by
 David Allen's land W by Ann Moore's land, and hath
 such shape & marks as the above plat represents.
 Survey 6th Dec^r 1797. by Wm. Alexander Mc Bee Esq
 Recorded 9th Dec^r 1797. Del^d self

State of South Carolina Pursuant to a
 warrant from Judge Thomas Com^r of
 loc^y N^o Side Saluda, dated 25th Oct^r 1797
 I have admeasured and laid out unto
 William Collins a tract of
 forty one acres of land in Pickney
 district on branches of Sugar river
 running N. & N. E. with William Coll
 Wm Collins land W. with John Collins land
 S. with old lines, and hath such shape
 and marks as the above plat represents.
 Survey 27th Oct^r 1797. James Wofford Esq
 Recorded 22^d Dec^r 1797 Del^d Wm Collins

