

32 South Carolina Pursuant to a warrant
 from John Thomas Esq. Comr. of loc^{ns}. I have ad-
 measured and laid out unto
 Robert Middleton a tract of 1000-
 acres of land in Greenville
 County on a creek of Saluda
 bounded on all sides by S. Middleton
 land and hath such form and
 marks as the above Plat represents
 Certified 31st Oct^r 1799
 Recorded 11th Nov^r 1799

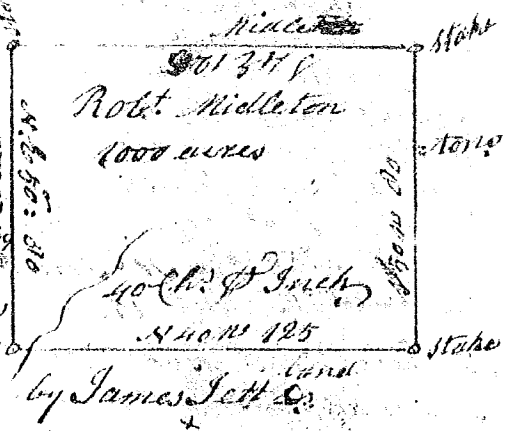

South Carolina Pursuant to a warrant from
 John Thomas Esq. Comr. of loc^{ns}. I have admeasured
 and laid out unto Charles D. Bradford a tract
 of one thousand acres of land in Washing-
 ton District and Greenville County on
 a creek out of the N. fork of Saluda
 river having such shape form and marks
 as the above plat represents. Certified for the 10th March
 1794 John Young Esq.
 Recorded 20th Sept^r 1794. Del. Young



South Carolina Pursuant to a
 warrant from John Thomas Esq.
 Comr. of loc^{ns}. I have admeasured
 and laid out unto Charles D. Bradford
 a tract of one thousand acres of land in
 Washington District & Greenville
 County on the North
 fork of Saluda river
 having such shape
 marks butting and
 bounding as the above
 plat represents
 Certified for the 8th day
 of March 1794

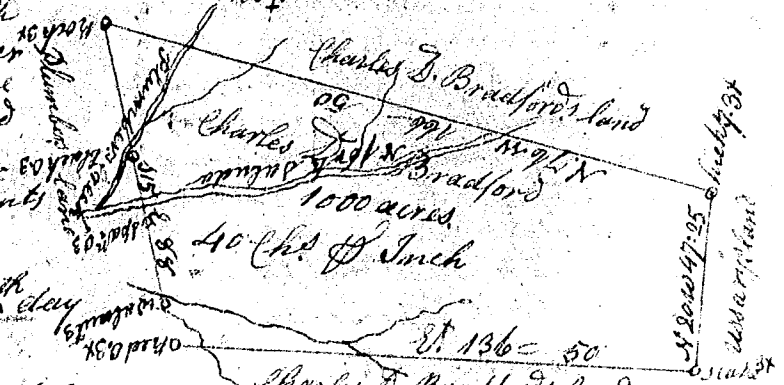

John Young Esq.
 Recorded 20th Sept^r 1794. Del. J. Young Esq.