

South Carolina Pursuant to a warrant from John Thomas Esq. Comr. of location. & date dated 1st Jan 1795 I have administered & laid out unto John Byggs Blackwell a tract of two hundred acres of land in branches of meadow & woods near Cross Mountain in Greenville County bounded by above Tuning &c by Frederick Smiths land &c & is unknown. S.E. by Frederick Haskings land and hath such steps form and marks as the above plat represents Survey of 16th Nov 1775.
 Recorded 17th Sept 1795 W. D. Thomas Esq. Secy. of the Court.

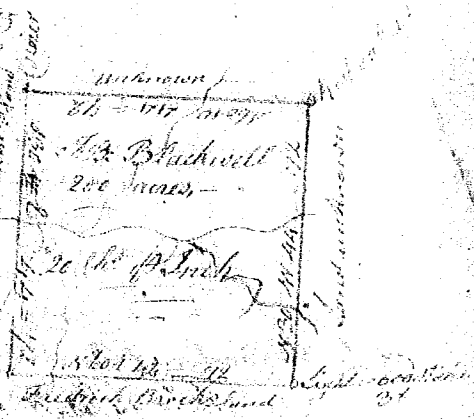

South Carolina Pursuant to a warrant from John Thomas Esq. Comr. of location. & date dated 25th Aug 1795 I have administered unto John Nicole a tract of two hundred acres of land in branches of meadow & woods near Cross Mountain in Greenville County bounded by above Tuning &c by John Smiths land &c & is unknown. S.E. by John Smiths land and hath such steps form and marks as the above plat represents Survey of 28th Sept 1775. W. D. Thomas Esq. Secy. of the Court.
 Recorded 30th Sept 1795

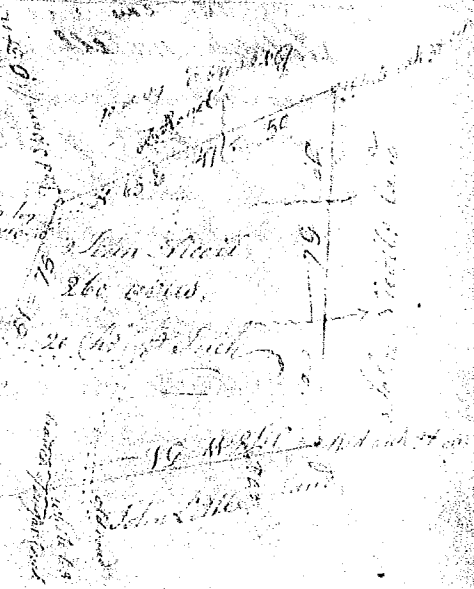

South Carolina Pursuant to a warrant from John Thomas Esq. Comr. of location. & date dated the 30th of March 1795 I have administered unto Francis Smith a tract of 200 acres of land situated on the banks of the river in Greenville County bounded by above Tuning &c by John Smiths land &c & is unknown. S.E. by John Smiths land and hath such steps form and marks as the above plat represents Survey of 16th Nov 1775.
 Recorded 17th Oct 1795 W. D. Thomas Esq. Secy. of the Court.

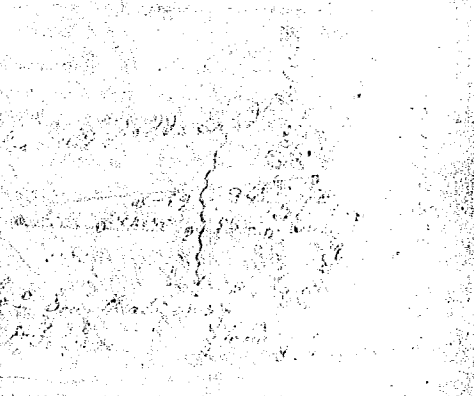

[Faint, mostly illegible text, likely bleed-through from the reverse side of the page.]