

South Carolina/Pursuant to a warrant from
 John Thomas Esq. Comr. of loc^{ns} N^o side Saluda, I have
 measured and laid out unto William Taylor tract of
 one hundred and forty seven acres of land in
 Spartanburg County Pinkney District on the
 creek waters of Great river, bounded E. by his own
 Old lands N. by Nathaniel Grayson land W. by Miller
 Richman's S. by land of William Hoopland, and
 hath such shape form & Marks as the above Plat
 Represents. - Survey 10th April 1795.

Recorded 23rd June 1795. Del. M. Bee Vardry M. Bee Esq.

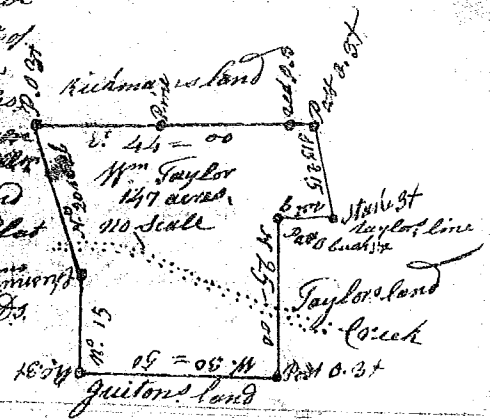

South Carolina/Pursuant to a warrant from
 John Thomas Esq. Comr. of loc^{ns} N^o side Saluda, I have
 measured and laid out unto Thomas Cole
 tract of 199 acres of land in Spartanburg
 County Pinkney District on the
 waters of the Beaver Dam creek a branch
 of thickety creek bounded E. by Rich^{ts} W.
 rights land N. by William Hoopland & William
 Thomson S. by said Cole, and hath
 such shape form & Marks as the
 above Plat Represents. -
 Survey 20th April 1795.

Recorded 23rd June 1795. by Vardry M. Bee Esq. Del. M. Bee

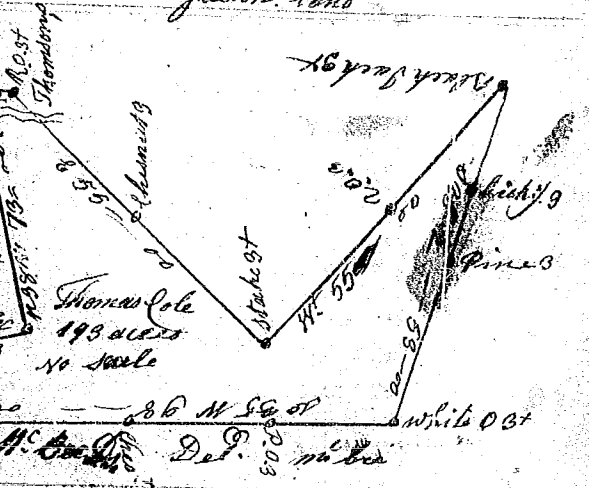

South Carolina/Pursuant to a warrant from
 John Thomas Esq. Comr. of loc^{ns} N^o side Saluda, I
 have measured and laid out unto John Atkinson
 tract of 256 acres of land in Union County
 Pinkney District on the head waters of Quilt
 creek, bounded E. by old Johnsons, W. by the
 said S. by Powers, Lambins, & Jones &
 hath such shape form & Marks as the above
 Plat Represents. Survey 3rd March 1795.

Recorded 23rd June 1795. Vardry M. Bee Esq. Del. M. Bee



South Carolina/Pursuant to a warrant from John Thomas Esq.
 Commissioner of locations N^o side Saluda, dated 4th May 1795,
 I have admeasured and laid out unto Nathan Bishop
 tract of one hundred & twenty four acres of land in
 Pinkney District, Spartanburg County on little Slaving
 Stone branch of Lawsons fork creek of Picolet river
 Bounding lines turning S.E. & N.E. on Peter Louisa's
 W. & S. on governor Moultrie's land, so called, N.W. &
 on William Bishops N.E. & S.W. on Philip
 M. Murdys N.E. on Edmond Bishop's S.E.
 on vacant land, and hath such shape &
 Marks as the above Plat represents.

Survey 5th May 1795.

W. Benson Esq.

Recorded 2nd July 1795. Del. H. Bishop

