

Pursuant to a warrant from John Thomas Esq. Com. of loc. 21 dated 18th April 1795, I have adm. measured and laid out unto John Diller a tract of 100 acres of land bounded N. by Joseph Diller land, or 60 William Pickens land, or by William Galtens land, or by William Poplins land, and hath such shape form & marks as the above Plat represents. Surveyed 21st April 1795. J. Young

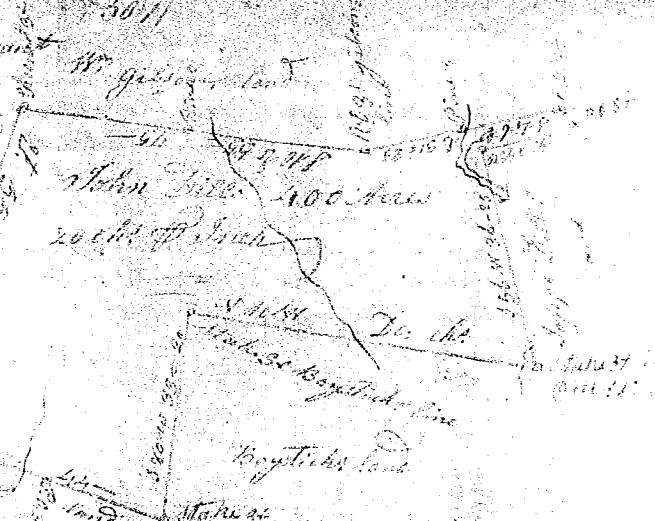

South Carolina / Pursuant to a warrant from John Thomas Esq. Com. of loc. 21 dated 18th April 1795, I have adm. measured and laid out unto David Leech a tract of thirty two acres of land in Pinkney District, Spartanburg County on both sides of Soffahs branch of Thomsons Creek waters of Carolat River, bounded S.E. by Colo ... land S.W. by Thomas Bartons land, W. by Robt ... land, and hath such shape form and marks as the above Plat represents. Surveyed 21st April 1795. Recorded 14th May 1795.

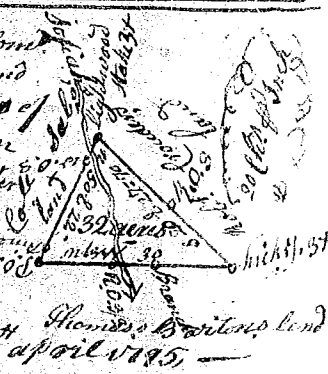

John Young Sur. G.

South Carolina / Pursuant to a warrant from John Thomas Esq. Com. of loc. 21 dated 20 Sept. 1793, I have adm. measured and laid out unto Mathew Gentry a tract of 90 acres of land in Pinkney District, Spartanburg County on both sides of Michaels Creek waters of Broad River, bounded N.E. & N.W. by ... land S.E. by said Gentry, & Sanders land, S.W. by Hopkins land, and hath such shape form & mark as the above plat represents. Recorded 10th Patrick Sanders Sur. the 27th May 1795 (Elapsed) J. Young

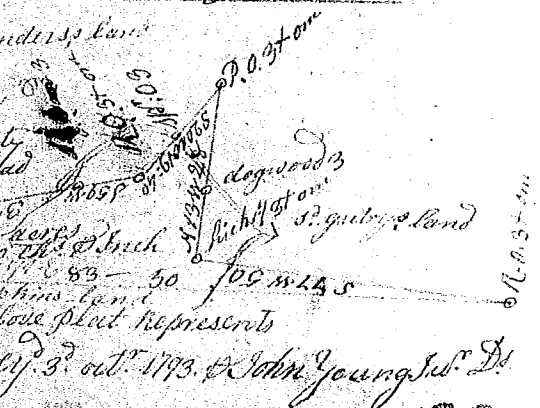

Surveyed 3rd Oct. 1793. John Young Sur. G.

South Carolina / Pursuant to a warrant from John Thomas Esq. Com. of loc. 21 dated ... I have adm. measured and laid out unto John Bird a tract of three hundred & fifty acres of land situate on the waters of Gilby Creek in Union County Pinkney District bounded N. by William Steens land S. by W. Right Alexander, and E. & W. by ... land, and hath such shape form and marks as the above Plat represents. Surveyed 15th May 1795. Recorded 24th May 1795. J. Young

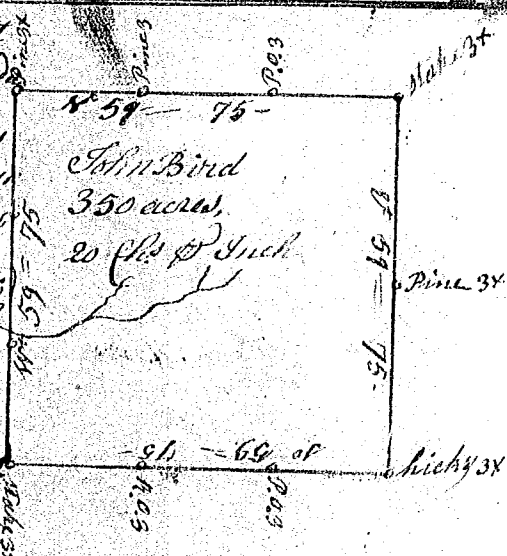

W. Right Alexander

Recorded 24th May 1795. J. Young