

State of N. Carolina, Pursuant to a warrant from John Thomas Esq. Sheriff of Guilford Co. dated 20th Febry 1795. I have measured and laid out into Ephraim Elder tract of four hundred and forty four acres of land in Brunswick County on Cherokee River bounded 1/2 mi. by the said river, bounded 1/2 mi. by the land laid out for John Thomas Esq. and other sides vacant or unknown and with such shape, marks, but large & bounding, as the above that represents, certified the 20th Febry 1795.

Recorded 27th Febry 1795.

John Thomas Esq.

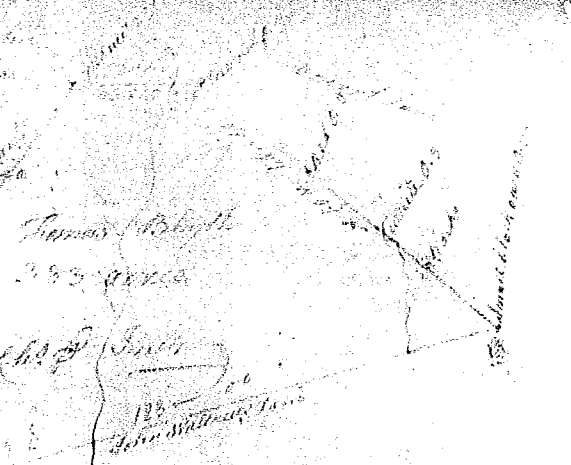

State of N. Carolina, Pursuant to a warrant from John Thomas Esq. Sheriff of Guilford Co. dated 20th Febry 1795. I have measured and laid out into Ephraim Elder tract of four hundred and forty four acres of land in Brunswick County on Cherokee River bounded 1/2 mi. by the said river, bounded 1/2 mi. by the land laid out for John Thomas Esq. and other sides vacant or unknown and with such shape, marks, but large & bounding, as the above that represents, certified the 20th Febry 1795.

Recorded 27th Febry 1795.

John Thomas Esq.

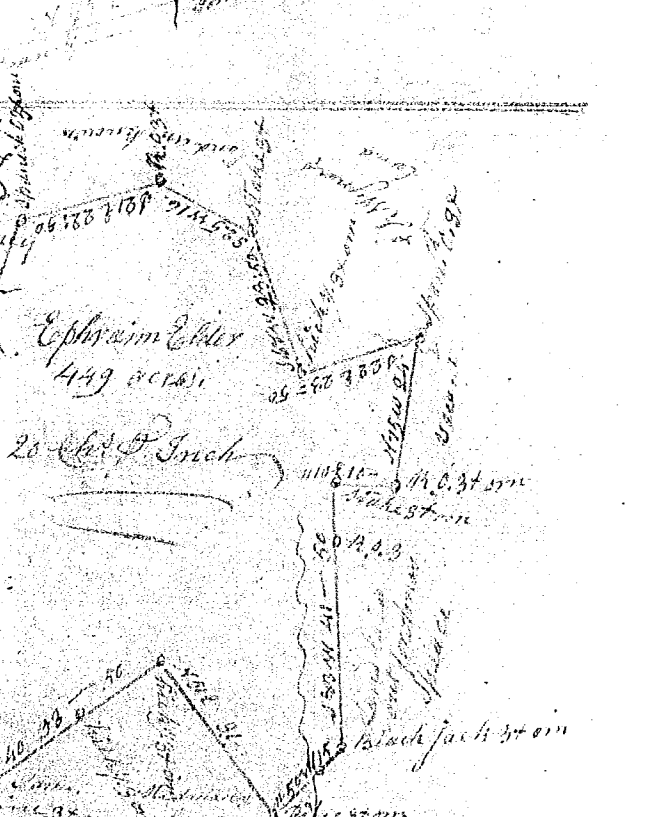

State of N. Carolina, Pursuant to a warrant from John Thomas Esq. Sheriff of Guilford Co. dated 20th Febry 1795. I have measured and laid out into Samuel M. M. M. tract of four hundred and forty four acres of land in Brunswick County on Cherokee River bounded 1/2 mi. by the said river, bounded 1/2 mi. by the land laid out for John Thomas Esq. and other sides vacant or unknown and with such shape, marks, but large & bounding, as the above that represents, certified the 20th Febry 1795.

Recorded 27th Febry 1795.

John Thomas Esq.



State of N. Carolina, Pursuant to a warrant from John Thomas Esq. Sheriff of Guilford Co. dated 20th Febry 1795. I have measured and laid out into Samuel M. M. M. tract of four hundred and forty four acres of land in Brunswick County on Cherokee River bounded 1/2 mi. by the said river, bounded 1/2 mi. by the land laid out for John Thomas Esq. and other sides vacant or unknown and with such shape, marks, but large & bounding, as the above that represents, certified the 20th Febry 1795.

Recorded 27th Febry 1795.

John Thomas Esq.

