

South Carolina, President's warrant to warrant
 from John Thomas Esq. (son of John Thomas)
 dated 2^d Sept. 1794. 1800 0774
 measured and laid out unto
 Sampson Bethel about of two
 hundred & seventy acres of land in
 District of South Carolina on branches
 of Spanish Creek, bounded N.W. by Bethel's
 land all other sides by vacant land
 or land unknown, and both such
 shape, form, sitting & boundaries
 as the above Plat represents.
 Dated the 3^d Sept. 1794 by
 Esq. (son of John Thomas)
 Recorded the 20th Oct. 1794. Det. (son of John Thomas)

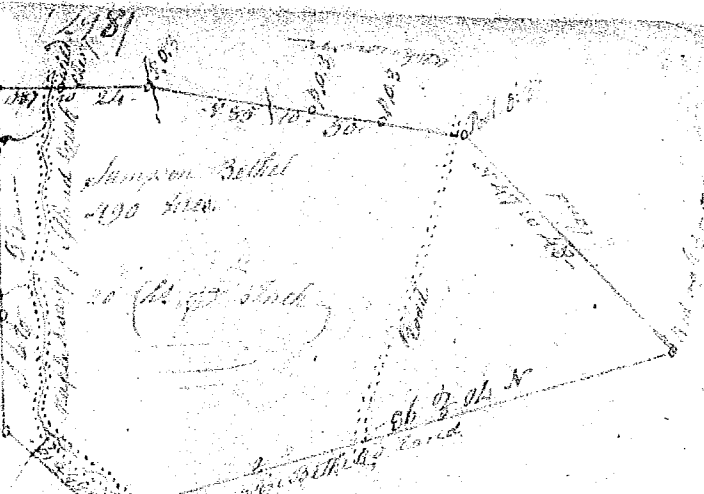

South Carolina, President's warrant to warrant
 from John Thomas Esq. (son of John Thomas)
 dated 2^d Sept. 1794. 1800 0774
 measured and laid out unto
 Sampson Bethel about of two
 hundred & seventy acres of land in
 District of South Carolina on branches
 of Spanish Creek, bounded N.W. by Bethel's
 land, N.E. by James Thomas's land and
 by Thomas's land, and both such
 shape, form, sitting & boundaries
 as the above Plat represents.
 Recorded the 20th Oct. 1794. Det. (son of John Thomas)

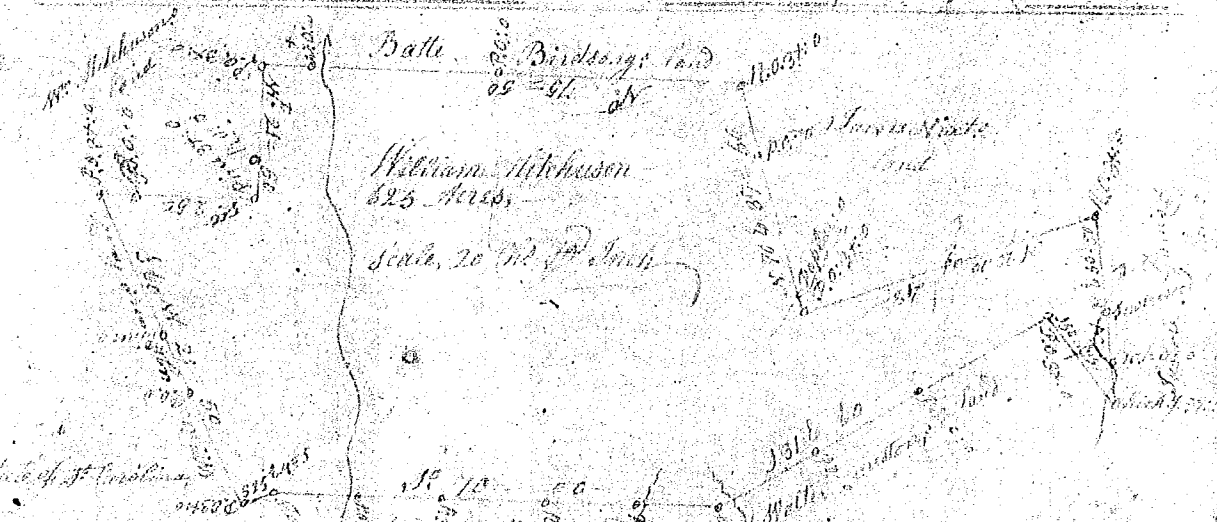
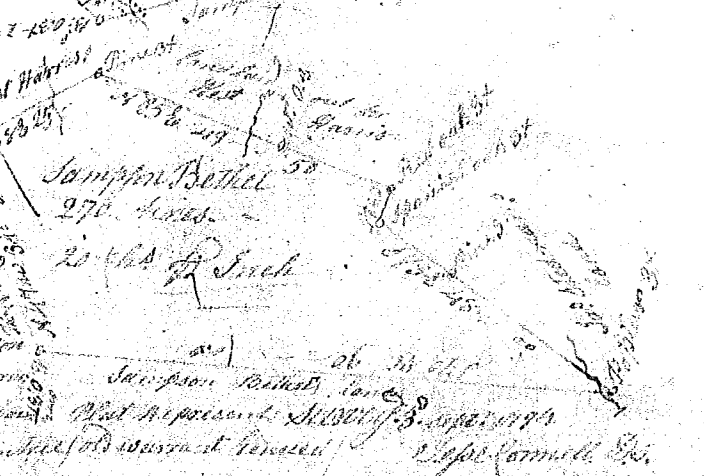

South Carolina, President's warrant to warrant
 from John Thomas Esq. (son of John Thomas)
 dated 2^d Sept. 1794. 1800 0774
 measured and laid out unto
 William Mitcheson about of two
 hundred & twenty five acres of land in
 District of South Carolina on branches
 of Spanish Creek, bounded N.W. by Bethel's
 land, N.E. by James Thomas's land and
 by Thomas's land, and both such
 shape, form, sitting & boundaries
 as the above Plat represents.
 Recorded the 20th Oct. 1794. Det. (son of John Thomas)