

State of N. Carolina Pursuant to a warrant from John Thomas
Comr. of S. C. Side Salubrity dated 22nd March 1794,

I have admeasured and laid out unto Terry Sorrent
a tract of four hundred & seventy nine
acres of land, lying on the N. branch
of the river bounded S.W. by absters
and K. Lamberson. S.E. vacant. S.W. 180
by Daniel Hancock, 838. by absters
and half such shape and marks
as the above Plat represents.

Witness my hand & seal this 23rd March 1794. J. Benson Esq.
Recorded 7th May 1794.

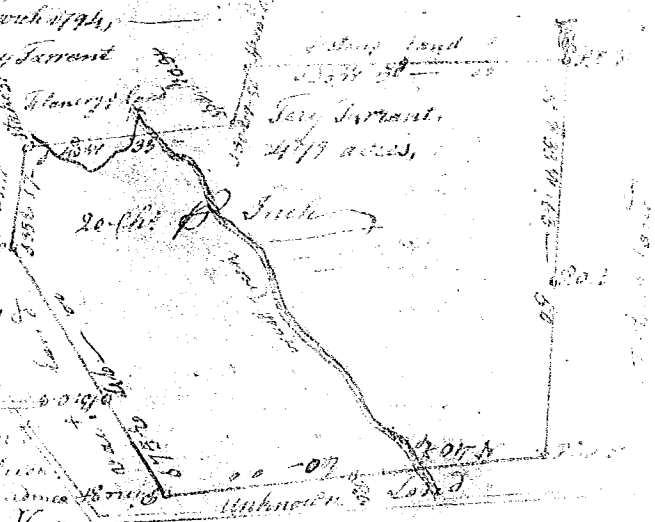

State of N. Carolina Pursuant to a warrant
from John Thomas Com. of S. C. Side Salubrity
dated 22nd March 1794. I have admeasured
and laid out unto Samuel Sorrent
a tract of land containing two hundred
and thirty five acres, situated in
Greenwich County, on the S.W. branch
of the river bounded S.W. by
W. C. Sorrent's land 288.
S.E. by Beals land N.W. by
Samuel Wilson's land, S.W. S.E. & S.W.
by John Pickens' land, & hath
such shape & marks as the above plat
represents. Given 4th April 1794.

Recorded the 7th May 1794. J. Benson Esq.

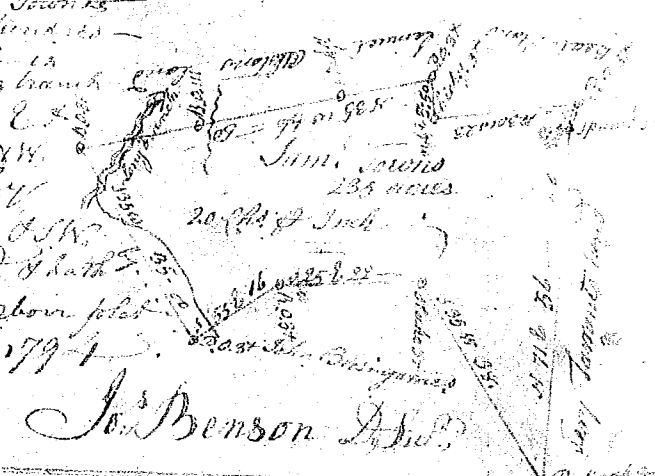

State of N. Carolina Pursuant to a warrant from John Thomas Comr.
of S. C. Side Salubrity dated 22nd March 1794. I have admeasured & laid
out unto Sheel Bookher a tract of 74 acres of land in said State
on branches of Saluda river, bounding by Lewis Huggins S.W. by
James Bluffingame's land S.E. by land survey for Samuel Bluffingame
& by land survey for John Huggins N.W. by Jewell land, &
hath such form and marks as the above Plat represents.

Witness my hand & seal this 7th Feb^{ry} 1794. Joseph Benson Esq.
Recorded 13th May 1794. J. Benson Esq.

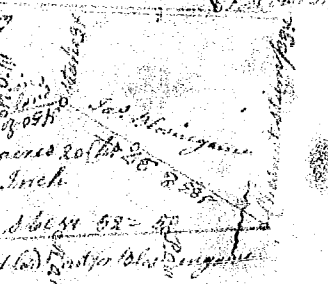

State of South Carolina Pursuant to a warrant
to a warrant from John Thomas Esquire Com. of S. C. Side Salubrity
dated the 31st of May 1794. I have admeasured
and laid out unto William Thomas, Esq. & Lechroon
a tract of five hundred acres of land
situate in Greenville County, on branches
of Thompson's Beaver dam creek of
Middle Leggar river - bounded S.W. by
Ting's Henning N.W. by land
survey for Wm Crow, S.E. by
vacant land S.E. by James Gordon's
land, S.E. by the ancient boundary
line for Dabney Brooks N.W. by John
Clements land, S.E. S.W. by land survey
Watson's land, and hath such form and
marks as the above plat represents.

Witness my hand & seal this 31st May 1794. J. Benson Esq.
Recorded the 31st May 1794.

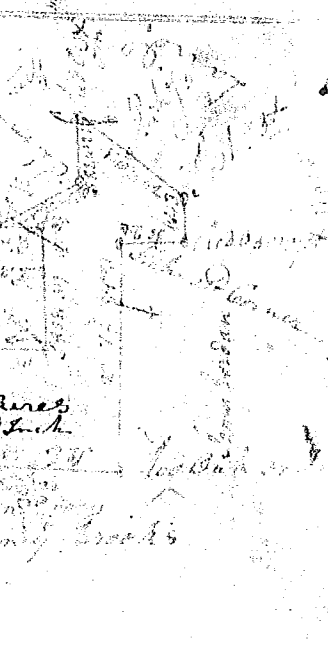

Recorded the 31st May 1794. J. Benson Esq.