

South Carolina Warrant to a warrant from  
 John Thomas Esq. com. of loc. dated 11 Nov 1798. I have  
 ad. measured and laid out unto John Ford a tract of four hundred  
 and twenty acres of land in Pinckney District Sparlanbury  
 county. Bounded with & square forks of Tyger river bounded  
 E. by James Hillers land 500 yds. by James Hillers land 500 yds.  
 land laid out to Joseph Atkins Esq. by John Ford's land  
 and hath such shape, marks & lines as the  
 above Plat represents  
 Survey 12<sup>th</sup> Oct. 1798  
 by Jesse Connell Esq.

Record 10<sup>th</sup> Dec. 1798  
 J. G. Elder



South Carolina Warrant to a warrant from  
 John Thomas Esq. com. of loc. dated 25 Nov 1798  
 I have ad. measured and laid out unto Ephraim Ueber  
 a tract of six hundred & fifty eight acres of land  
 in Pinckney District Sparlanbury county  
 one of how has fresh of Accot near  
 bounded E. by James Stearns land  
 N. by William Shedd land 500 yds. by  
 James Turners land all other sides  
 by lands unknown and having  
 hath such shape form & marks as the  
 above Plat represents  
 Survey 3<sup>rd</sup> Dec. 1798  
 by Jesse Connell Esq.  
 Received 10<sup>th</sup> Dec. 1798  
 J. G. Elder

Ephraim Ueber  
 658 acres  
 20 Ch. 1/2 Inch

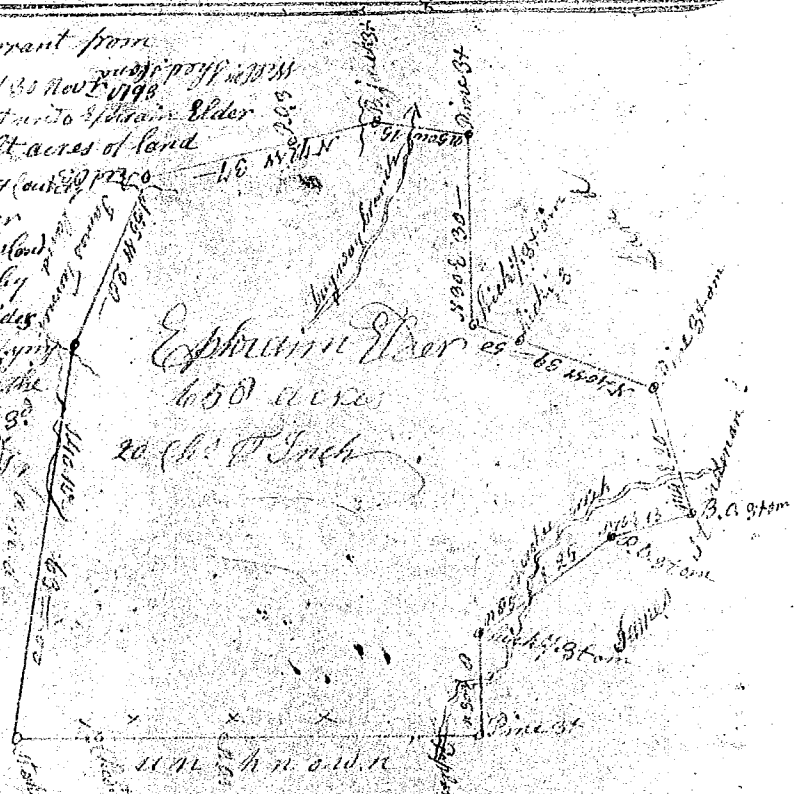

South Carolina Warrant to a warrant from John Thomas  
 Esq. com. of loc. dated 11 Nov 1798. I have  
 ad. measured and laid out unto John Steen  
 a tract of Three Hundred  
 acres of land in Pinckney District  
 on the Neck between South  
 & North Tyger rivers bounded  
 by land of Adam & David Gow  
 & Charles  
 & hath such shape form and  
 marks as the above plat  
 represents  
 Survey the 23<sup>rd</sup> of May 1799.  
 By Ludov. M. Beards  
 Recorded the 30<sup>th</sup> Dec. 1798

John Steen  
 300 Acres

20 Ch. 1/2  
 an Inch

