

200
 19 Carolina Pursuant to a warrant from John Thomas Esq. (one of the Justices of the Peace) I have surveyed and laid out unto John M. Whorter about of 254 acres of land in 9th District, on the waters of Pacolet river, bounding on a line running S. 30. W. on land surveyed for John Cole, on a line W. on land surveyed for Thomas Brandon by a line N. 60. E. by land survey Wm. Gillis, on a line running S. 82. E. by land survey for John M. Whorter, all other sides vacant land. Surveyed by Wm. Gillis Nov. 1790. J. M. Gaston Esq.

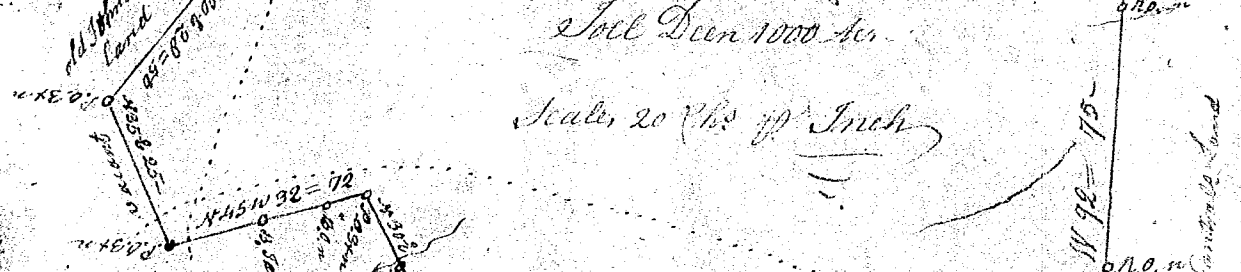
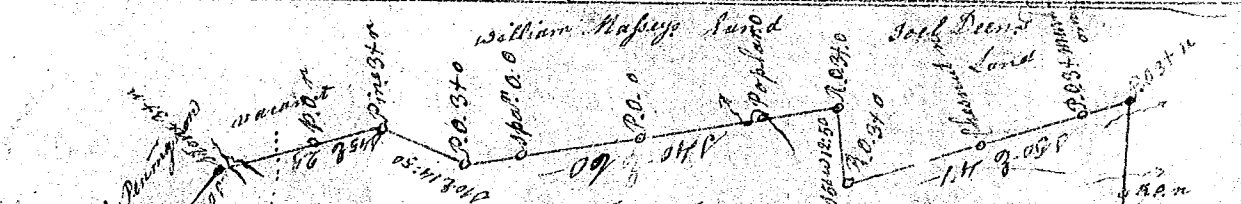
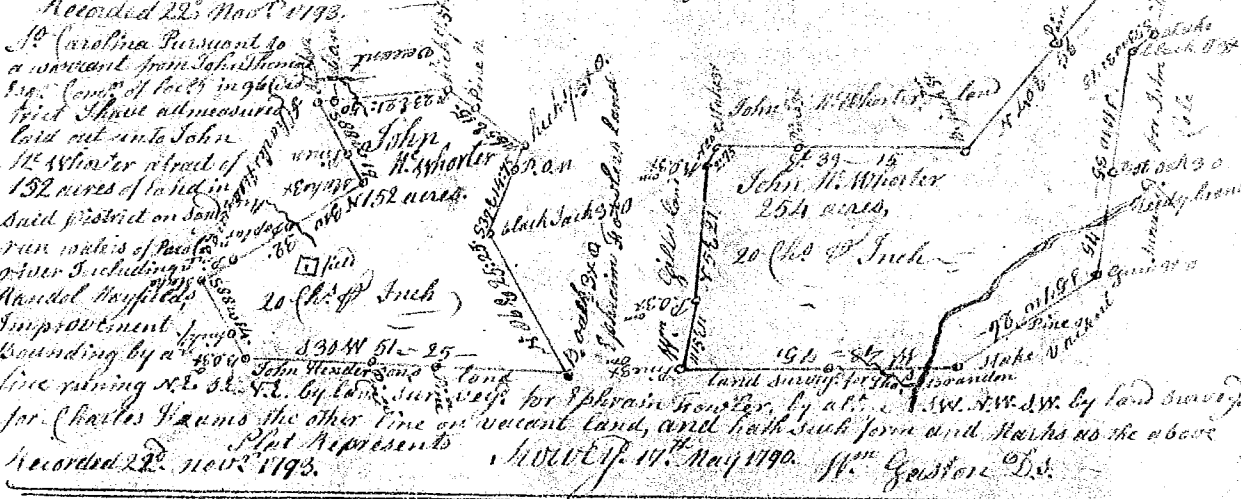

State of S^c Carolina Pursuant to a warrant from John Thomas Esq. (one of the Justices of the Peace) I have surveyed and laid out unto John Deen a tract of 1000 acres of land on the branches of lower Sugar river in Pickens County, bounding S. 2. E. with Joel Deen's land, S. 82. E. with William Mafey's & John Pennington lands, S. 82. E. with John Patton's lands, and both such shape & marks as the above Plat represents. Surveyed by Wm. Gillis Nov. 1793. J. M. Gaston Esq.

[Faded and mostly illegible text, possibly a continuation of the survey description or a separate document.]