

To a warrant from John Thomas
 Esq. Com. of Saluda dated the 5th
 April 1793. I have admeasured &
 laid out unto Mr. Brownland
 a tract of three hundred acres
 Land Situate on the N. side
 of Saluda River in Greenville County
 bounded by lines shown & set out
 by Thomas Murphy & set out
 N. E. by Mr. Shachert's Adam
 Conkly's lands by N. W. by Abraham
 Bradley's land the line of the
 various courses of Saluda River &
 hath such shape form
 buttings & bounding as the above plat
 represents

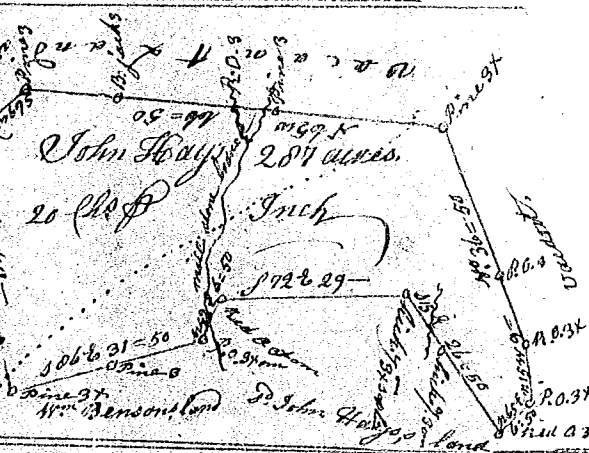

Surveyed & the 2nd of Aug. 1793. By James Kilgore Esq.
 Recorded the 19th day of Nov. 1793 Set. the said Kilgore

9th Carolina Pursuant to a warrant from
 John Thomas Esq. Com. of Saluda dated 7th Oct.
 1793. I have admeasured and laid out unto
 John Hays a tract of Two hundred & eighty-
 seven acres of land in Pickens District
 in Spartanburg County on branches of Spring
 Creek bounded S. by William Benson
 and John Hays's lands, all other sides by
 vacant land, and hath such shape form
 buttings & bounding as the above plat
 represents. Surveyed Oct. 1793. Set. J. J. J. J.
 Recorded 19th Nov. 1793. Set. J. J. J. J.



10th Carolina Pursuant to a warrant from
 John Thomas Esq. Com. of Saluda dated 10th Oct.
 1793. I have admeasured and laid out
 unto John Smith a tract of Two hundred &
 six acres of land Situate in Washington District
 on both sides of the River & a branch of Spring
 Creek in Greenville County. Bounding by lines shown
 & set out by the lines of the lands of
 1876 by land granted to Geo. Day & set out by
 Young's land N. E. & W. by John Smith
 lands & hath such form & markings as
 the above plat represents

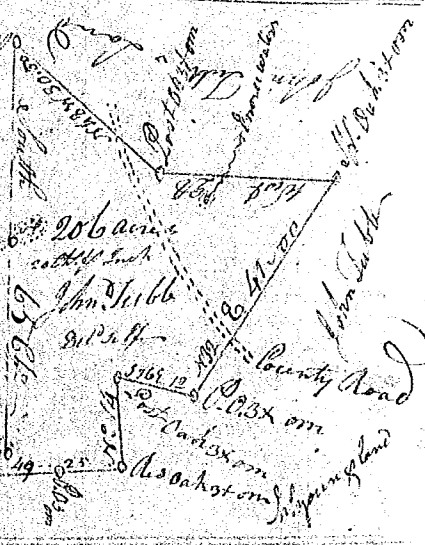

Surveyed the 29th Oct. 1793
 Recorded the 9th Nov. 1793

11th Carolina Pursuant to a warrant from
 John Thomas Esq. Com. of Saluda dated 21st Nov.
 1793. I have admeasured and laid out
 unto John Smith a tract of Three hundred &
 thirty three acres of land in
 Pickens District on branches of Spring
 Creek in Spartanburg County on both
 sides of the Spring Creek from Greenville
 to Spring Creek. Bounding by lines shown
 & set out by the lines of the lands of
 Road by land set out by the lines of the
 land set out for Wm. Shachert's, 1876 by
 land set out for Roger Smith, 1876 by
 land set out for Daniel Smith, & hath such
 shape & markings as the above plat represents

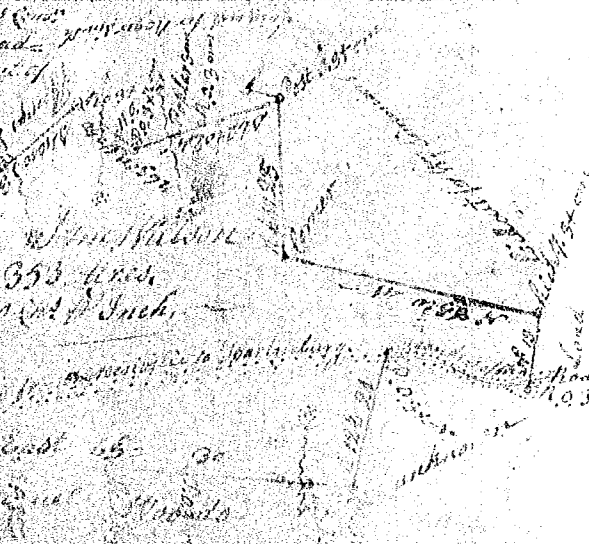

Surveyed the 21st Nov. 1793
 Recorded the 17th Dec. 1793