

So Carolina Pursuant to a warrant from John Thomas Esq. Comr of Lou. dated 24<sup>th</sup> Oct 1793. I have admeasured and laid out unto Thomas Farrer a tract of land in Washington District on the head branches of the Middle fork of Saluda bounded by lines N. 88 & 82. E. by Thomas Farrers land - S. E. by vacant land, and hath such form and marks as the above plat represents Recorded 8<sup>th</sup> Nov 1793

(269)

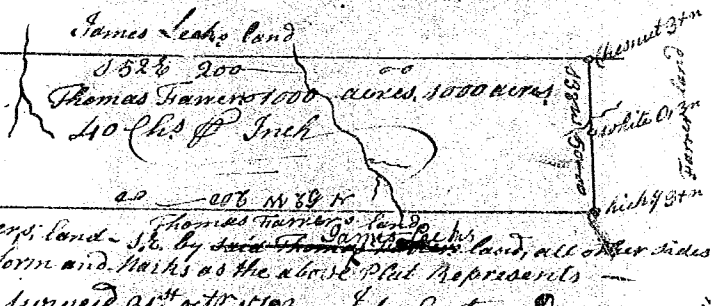

So Carolina Pursuant to a warrant from John Thomas Comr of Lou. dated 24<sup>th</sup> Oct 1793, I have admeasured & laid out unto Thomas Farrer a tract of one thousand acres of land in Washington District on the head branches of the Middle and N fork of Saluda bounded by lines running N. 88, 82, & 82. E. by Thomas Farrers land and all other sides by vacant land & hath such form and marks as the above plat represents Recorded 8<sup>th</sup> Nov 1793

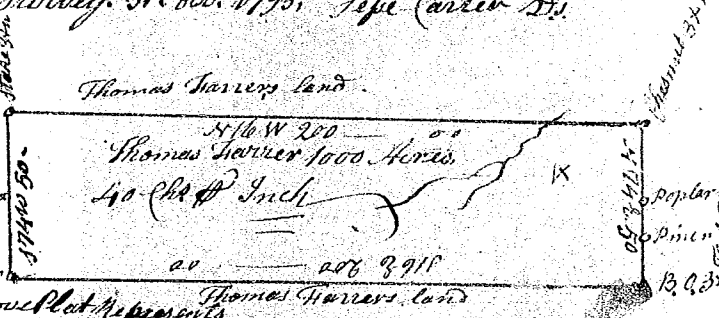

So Carolina Pursuant to a warrant from John Thomas Esq. Comr in the District of Washington dated the 24<sup>th</sup> Oct 1793. I have admeasured & laid out unto Thomas Farrer a tract of 1000 Acres of land situated in the District aforesaid on the head branches of the Middle fork of Saluda bounded by lines running N. 88, 82, & 82. E. by Thomas Farrers land, N. 88 by the land of Thomas Farrer such form and marks as the above plat represents Recorded the 8<sup>th</sup> Nov 1793

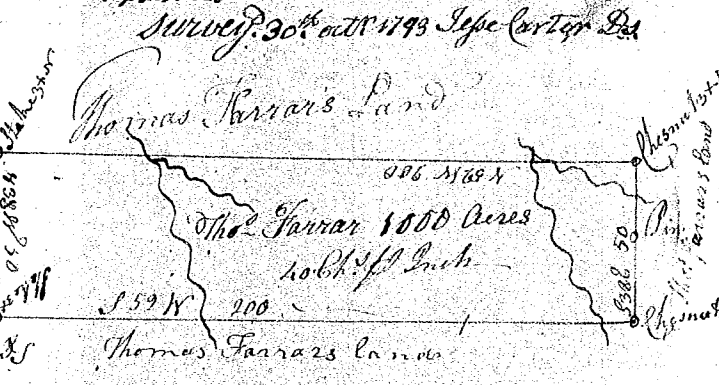

So Carolina Pursuant to a warrant from John Thomas Esq. Comr dated the 24<sup>th</sup> Oct 1793. I have admeasured & laid out unto Tho. Farrer a tract of 1000 Acres of land situated in Washington District on the head branches of a branch of the Middle fork of Saluda River bounded by lines running N. 88, 82, & 82. E. by Thomas Farrers land, N. 88 by vacant land & hath such form and marks as the above plat represents Surveyed the 31<sup>st</sup> Oct 1793 by Jefe Carter D.S. Recorded the 8<sup>th</sup> Nov 1793

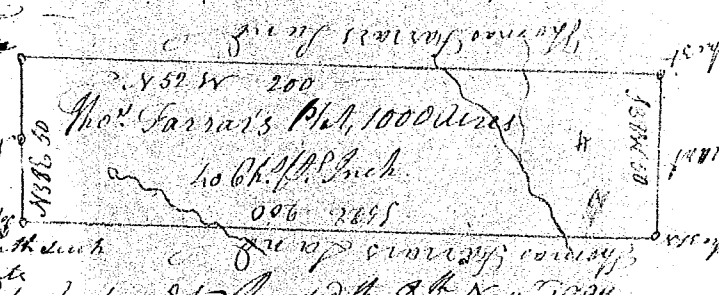

So Carolina Pursuant to a warrant from John Thomas Esq. Comr dated the 24<sup>th</sup> Oct 1793 I have admeasured & laid out unto Thomas Farrer a tract of 1000 Acres of land situated in Washington District on the head branches of Green River bounded by lines running N. 88, 82, & 82. E. by Thomas Farrers land, S. E. by vacant land & hath such form and marks as the above plat represents Surveyed the 31<sup>st</sup> Oct 1793 by Jefe Carter D.S. Recorded the 8<sup>th</sup> Nov 1793

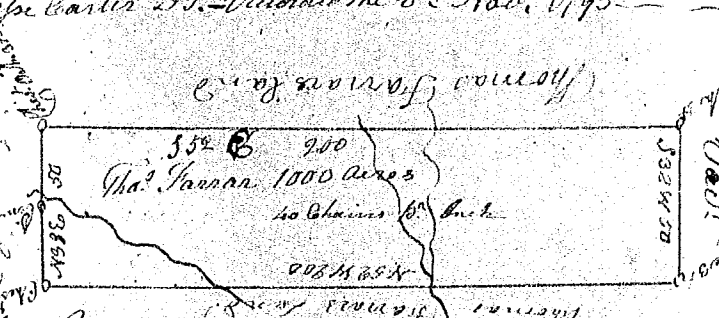

So Carolina Pursuant to a warrant from John Thomas Esq. Comr in the District of Washington dated the 24<sup>th</sup> Oct 1793. I have admeasured & laid out unto Thomas Farrer a tract of 1000 Acres of land situated in the District aforesaid on the head branches of Green River bounded by lines running N. 88, 82, & 82. E. by Thomas Farrers land, the other side vacant, & hath such form and marks as the above plat represents Surveyed the 31<sup>st</sup> Oct 1793 by Jefe Carter D.S. Recorded the 8<sup>th</sup> November 1793

