

State of S^c Carolina Pursuant to a Warrant
 from John Thomas Esq^r Com^r of
 loc^y Dated 16th Oct^r 1793 I have
 admeasured and laid out unto
 William D. Thomas
 a tract of seven hundred and fifty
 acres of land in Pinkney district
 on the head branches of Sautons fork
 of Pocolat river and three small
 branches of St. Tugar river in Spartan-
 burg County. Bounded by lines running N.W. & N.E. by David Goodlets N.W. & E. by
 Bishops, N.W. & N.E. by Robert Princes N.W. by M^r Donells lands N.W. & W. by lands un-
 known S.E. & S.W. by land surveyed for Maximilian Conner S.E. & S.W. by Jamesons land and
 hath such form and Marks as the above Plat represents. Survey^d 21st Oct^r 1793
 Recorded 24th Oct^r 1793,
 W^m D. Thomas Esq^r

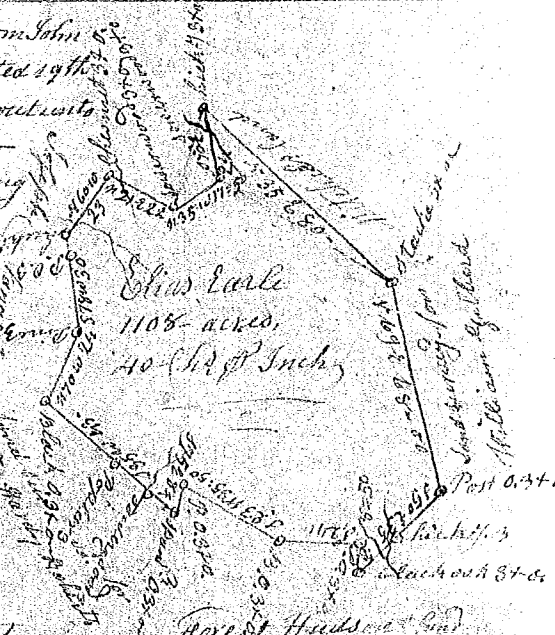

South Carolina Pursuant to a warrant from John
 Thomas Com^r of loc^y side saluda dated 19th
 Aug^t 1793, I have admeasured and laid out unto
 Elias Earle a tract of Eleven hundred &
 eight acres of land situate in Washing-
 ton District on the head branches
 of Needy river by Mountain Creek
 of Moore river, bounding by lines
 running N.E. & N.W. by land survey^d
 for Joseph Longston William Gilbert
 and Mitchels lands, S.E. & S.W. by land
 survey^d for Hardy Roberts & Forest
 Hudson, all other sides by vacant land
 and hath such form and Marks as the
 above Plat represents.
 Survey^d 17th Aug^t 1793.
 Recorded 8th Nov^r 1793. Jesse Carter Esq^r



South Carolina Pursuant to a
 warrant from John Thomas Esq^r
 Com^r of loc^y dated 19th Aug^t 1793
 I have admeasured and laid out unto
 Elias Earle a tract of one hundred and
 thirty three acres of land in Washington
 District on the head waters of Richland and
 Creek waters of Needy river, bounding
 N. by land survey^d for Joseph Longston, S.E. by land survey^d
 for Hardy Roberts, S.W. by Samuel James a lston all other sides vacant,
 and hath such form and Marks as the above Plat represents.
 Survey^d 19th Aug^t 1793. Jesse Carter Esq^r
 Recorded 8th Nov^r 1793

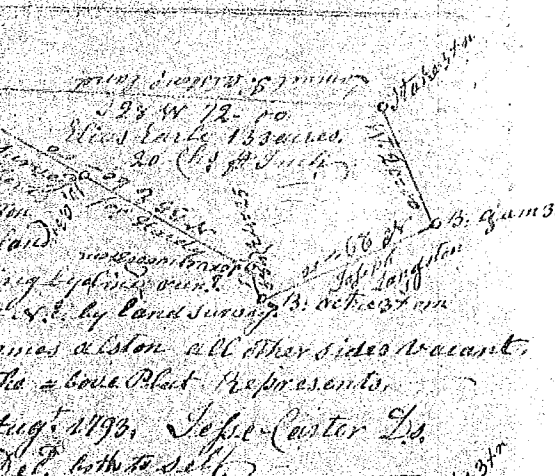

South Carolina Pursuant to a warrant from
 John Thomas, Com^r of loc^y Saluda dated 16th
 Oct^r 1793, I have admeasured and laid out
 unto Thomas Farmer a tract of one thousand acres
 of land in Washington District on the head br-
 nches of the N.E. Middle fork of Saluda
 bounded by lines running S.W. & N.W. by
 Thomas Farmers land S.E. by William Connel-
 lous, and all other sides by vacant land
 and hath such form and Marks as the a-
 bove Plat represents. Survey^d 30th Oct^r 1793,
 Recorded 8th Nov^r 1793,
 Jesse Carter Esq^r

