

South Carolina Pursuant to a warrant (1766)
 John Thomas, Comr. of loc^{ns} dated 15th June 1793.
 I have admeasured and laid out unto Joseph
 Carver a tract of nine hundred acres of land
 in Spartanburg County, on both sides of
 Greens Creek & Meadows Creek the waters
 of Lawson's Creek & 3 small branches of
 the Pacolatrius descend to East by Eli
 M. Wags land to M. Dawls land & to the NW
 by Satterfields by W. W. Kings Lands, & all other
 sides by vacant Land & hath such form & marks
 as the above plat represents.

Survey'd the 18th Sept. 1793,
 the young Jun^r D. S.

Recorded the 23rd Oct. 1793 Det. S. H.



South Carolina Pursuant to a warrant
 from John Thomas Esq^r Comr. of loc^{ns} dated
 16th Oct. 1793, I have admeasured and
 laid out unto W^m L. Thomas,
 a tract of five hundred acres of
 Land in Pinkney District on both
 sides Greens River of Lawson's fork &
 other branches of said waters of Pacolatrius
 river in Spartanburg County -
 bounded lines running N. 71 W. by
 Isaac Bishops land N. E. by W. M. by
 M. Dowells lands N. E. by Bishops
 & Wests land, the
 other sides by vacant
 at Washington lands
 and hath such form
 and marks as the
 above Plat
 represents.

Survey'd 24th Oct. 1793, W^m L. Thomas, D. S.

Recorded 23rd Oct. 1793,

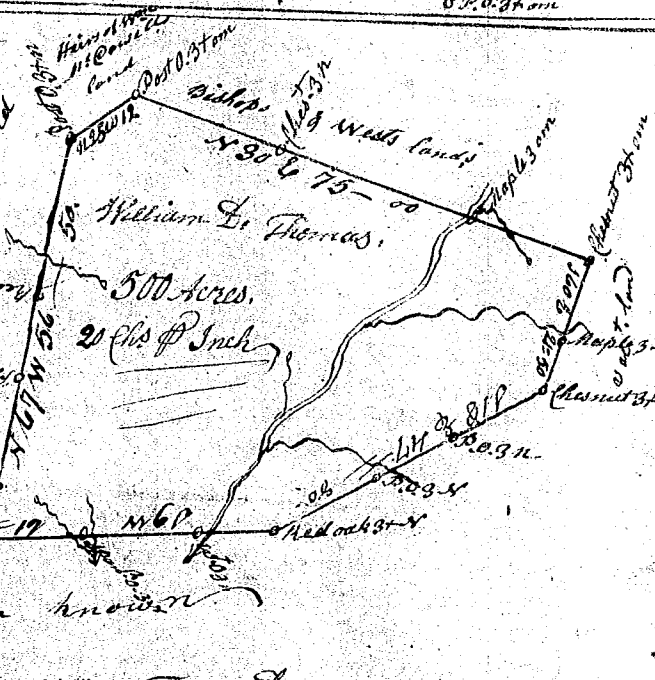

South Carolina Pursuant to a warrant from John
 Thomas Esq^r Commissioner of locations dated 16th
 Oct. 1793, I have admeasured & laid out
 unto W^m L. Thomas a tract
 of one thousand acres of land situate
 in Pinkney District on both sides of
 Byrd & Holsons fork of the Pacolatrius
 and three small branches of Lawson's
 fork of said river in Spartanburg
 County, bounding by a line running
 180 E. M. Wags & Carby's lands & by a line
 N. E. by M. Dowells & Bishops lands
 all other sides by ~~vacant~~ Land unknown
 and hath such form and marks as the above
 Plat represents.

Survey'd 19th Oct. 1793, W^m L. Thomas, D. S.

Recorded 24th Oct. 1793,

