

State of S<sup>c</sup> Carolina Cinchney Dist<sup>y</sup> (A. 242)

Pursuant to a warrant from Wm Thomas Esq<sup>r</sup> Com<sup>r</sup> Lo<sup>g</sup> dated the 25<sup>th</sup> day of Dec<sup>r</sup> 1792 I have admeasured & laid out unto Elisha Hedden a tract of One Hundred & Eighty two acres of land in the District situated lying on the branches of Sugar River running S. of E. & North. Millers Land N. of James Alexanders, N. E. with Barney's lands all other sides vacant I hath such shape & no marks as the above Plat Represents Surveyed the 21<sup>st</sup> January 1793

Recorded the 6<sup>th</sup> day of May 1793

In the same manner as above I have laid out unto Elisha Hedden 100. acres of land on the branches of the N. fork of Sugar River on all sides vacant with such shape & marks as the above Plat Represents - Surveyed the 20<sup>th</sup> January 1793

Recorded 6<sup>th</sup> May 1793

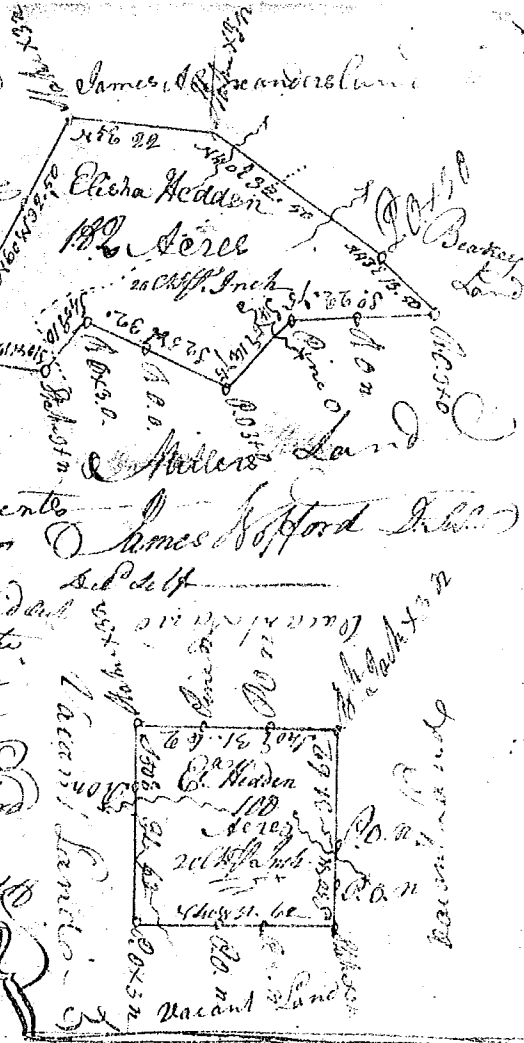

South Carolina Pursuant to a warrant from John Thomas Esq<sup>r</sup> Commissioner of Locations N<sup>o</sup> side Saluda river dated 1<sup>st</sup> March 1793, I have admeasured and laid out unto James West a tract of Two hundred and fourteen acres of land, situate in Greenville County, on a branch of the river formerly bounded by a line by a line running S. W. by James West, by a line running S. westward by John Hatcher S. E. Williams Land N. E. & S. E. by land survey for John Piles N. W. by Blacks Land, N. W. by Crafts Land, And hath such form and marks as the above Plat Represents. Surveyed 2<sup>nd</sup> March 1793

Recorded 6<sup>th</sup> May 1793



South Carolina Pursuant to a warrant from John Thomas Esq<sup>r</sup> Com<sup>r</sup> of Locations N<sup>o</sup> side Saluda dated 19<sup>th</sup> March 1793 I have admeasured and laid out unto Forest Hudson about 834 acres of land in Washington District, on the branches of Mountain Creek waters of Snowe river bounding by a line running N. W. by land survey for Bunnhill & S. on Lemuel James Astors Land N. on Isaac Green's Land S. E. on Patience Roberts Land all other sides on lands unknown, and hath such form and marks as the above Plat Represents. Surveyed 26<sup>th</sup> March 1793

Recorded 9<sup>th</sup> May 1793

Isaac Carter Esq.

