

State of S^c Carolina Pursuant to a warrant from John Thomas Esq^r Com^r of the S^c of S^c Carolina, dated 28th Sept^r 1792, I have admeasured and laid out unto Isaac Green a tract of one hundred and six acres of land, in Washington District on branches of Washby Creek of Noxle river in Greenville County bounding by a line running SW & E. by Highline land NW by S. James Adams, S. Isaac Green, S. E. and S. E. by Moses Lewis's land, and hath such form and Marks as the above Plat Represents,
 Surveyed 1st Dec^r 1792
 Recorded 15th April 1793
 J. H. D. Thomas Det^y

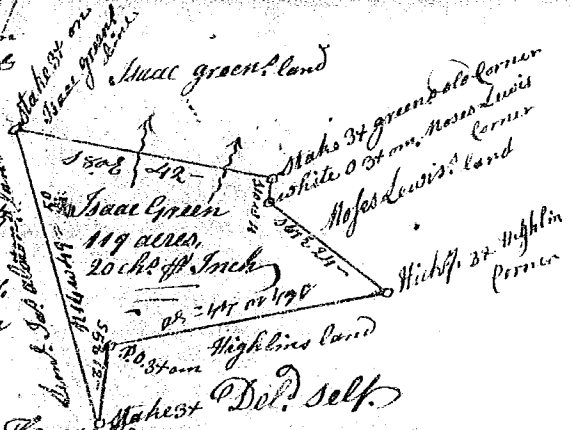

S^c Carolina Pursuant to a warrant from John Thomas Esq^r Com^r of the S^c of S^c Carolina, dated the 15th day of January 1793, I have admeasured unto Ben Davis Thomas a tract of One thousand two hundred and six acres of land, in Pickens District on branches of Washby Creek of S^c Carolina, in Spartanburg County, bounded by land survey of 1788, N. E. by land survey of 1788, S. W. by land survey of 1788, also West by land survey of 1788, and hath such form and marks as the above Plat Represents - Surveyed 19th Jan^y 1793 - by W. D. Thomas Det^y
 Recorded the 15th day of April 1793

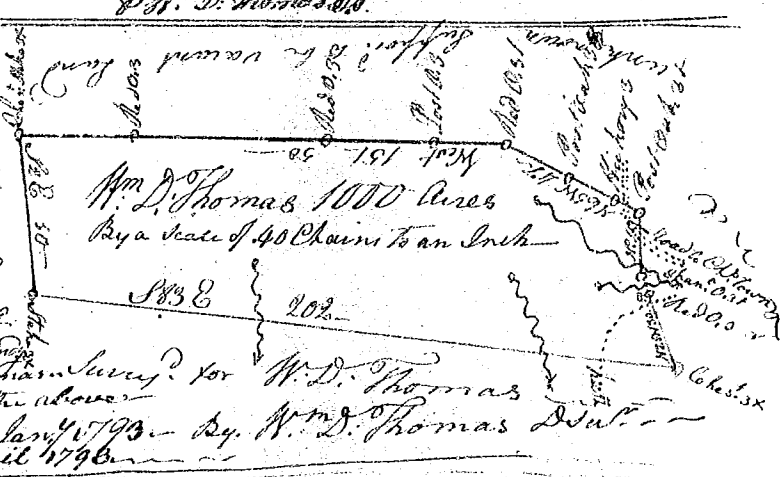

State of S^c Carolina Pursuant to a warrant from John Thomas Esq^r Com^r of the S^c of S^c Carolina, dated the 16th day of Jan^y 1793, I have admeasured unto William D. Thomas a tract of Nine hundred and forty acres of land, in Pickens District, on Washby Creek & East side fork of S^c Carolina, in Spartanburg County, bounding by a line running East by Graff's & Comp^y land N. E. by James Alexander & Mayson's land, N. W. by land survey for W. D. Thomas & S. E. by the Old Indian boundary line, and hath such form & marks as the above Plat Represents. Surveyed the 18th Jan^y 1793
 Recorded 15th April 1793
 by William Davis Thomas Det^y



State of S^c Carolina Pursuant to a warrant from John Thomas Esq^r Com^r of the S^c of S^c Carolina, dated the 16th day of Jan^y 1793, I have admeasured & laid out unto James Smith a tract of land lying on Kellops Creek a branch of Fairforest Creek of Tyger River, about five miles below the Cedar spring bounded N. by Buffington's land, W. by Connelly's land, S. by Gibbs's land, E. by James's land, and hath such shape, marks, and quantity, as the above Plat Represents, Certified for the 20th March 1793.
 Recorded 20th April 1793
 by J. Smith Det^y

