

State of South Carolina Pursuant to a warrant from John Thomas Esq. Comr. of Genl. I have admeasured and laid out unto Archibald Taylor a tract of four hundred and sixty two acres of land in greenville County on the branches of Musk Creek of Tugger-river, and a branch of moore river bounded S. Westwardly by a line running S. 10 E. by land laid out to Nathaniel Perry, S. E. wardly by a line running N. 10 E. & S. 15 E. by land laid out unto Michael Miller and Thomas Doeg N. E. by a line running N. 33 W. by land laid out unto Moses Shelby, all other sides by vacant land and water course and hath such shape and marks as the above Plat represents.



Survey. 18th Febr. 1793.
Recorded 6th April 1793. Del. George Salmon D^r wife

South Carolina Pursuant to a warrant from John Thomas Esq. Comr. of Genl. dated 22nd of febr. 1793, I have admeasured and laid out unto William Stephenson a tract of one hundred and ten acres of land in Pinkney District in spartanburg County on both sides of the Bee tree fork branch of South Carolina river & a small branch of Lawrence's fork, Bounded to the N. by So. Dixons land, N. E. by land surveyed for David M. Dowell, all other sides by vacant land, and hath such shape form & marks, as the above Plat represents.



Survey. 6th April 1793.
Recorded 8th April 1793. John Young Sur. G^r

South Carolina, Pursuant to a warrant from John Thomas Esq. Comr. of Genl. dated the 18th febr. 1793. I have admeasured and laid out unto Evan Watkins a Tract of four hundred and seventy three acres of land in Pinkney District spartanburg County on both sides of such Creek of Broad river, bounded S. by the State boundary line running N. 114 Ch. S. E. by Sharps land and vacant land S. W. by vacant land, and hath such shape form and marks as the above Plat represents.

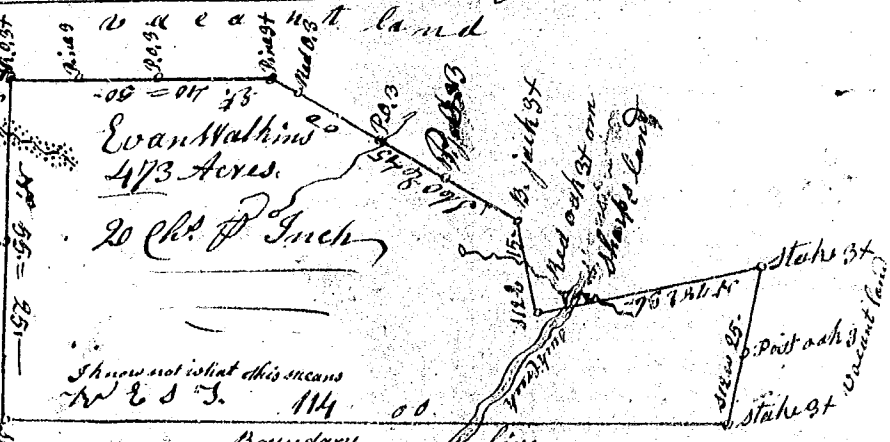

Recorded 8th April 1793. Survey. 7th March 1793. John Young Sur. G^r