

South Carolina, Pursuant to a warrant from John Thomas Esq. Comr. of locatns N. Saluda river 6th district dated 2^d Jan'y 1799, I have admeasured and laid out unto James Jett a tract of one thousand acres of land situate in Greenville County on the branches of Saluda anduddy rivers bounded by lines runnings & on Thomas land, N.E. & E. on Blasingame's land N.W. & S.W. on other Thomas's land N.E. & N. on hills and Neardies land S.W. on Thomas Dunning's land S. on Mountains land E. & S. on Lewis Myers land, all other sides on vacant lands and hath such shape and marks as the above plat represents,

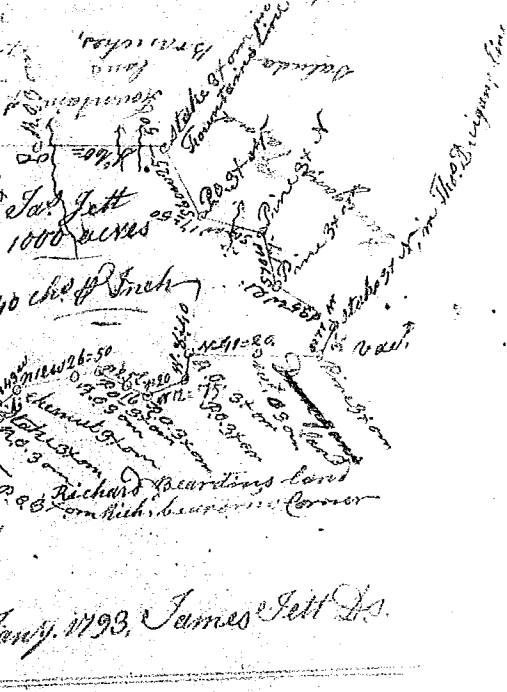

South Carolina, Pursuant to a warrant from John Thomas Esq. Comr. of locy A Saluda river dated 7th day of March 1799, I have admeasured and laid out unto David McCoy a tract ninety four acres of land in 96th district & County of Greenville, on a branch of creek of Saluda river bounding by a line running on land laid out to Billy White river S.E. & on lines of the above said David McCoy, S.E. on land of Jacob Gardner & son, on vacant land, and hath such shape and marks as the above plat represents,

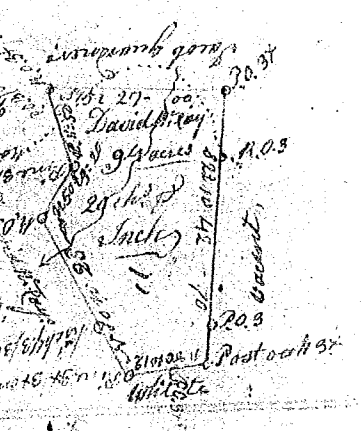

South Carolina, Pursuant to a warrant from John Thomas Esq. Comr. of locatns N. Saluda river 6th district dated 2^d Jan'y 1799, I have admeasured and laid out unto James Jett a tract of one thousand acres of land situate in Greenville County on the branches of Saluda anduddy rivers bounded by lines runnings & on Thomas land, N.E. & E. on Blasingame's land N.W. & S.W. on other Thomas's land N.E. & N. on hills and Neardies land S.W. on Thomas Dunning's land S. on Mountains land E. & S. on Lewis Myers land, all other sides on vacant lands and hath such shape and marks as the above plat represents,

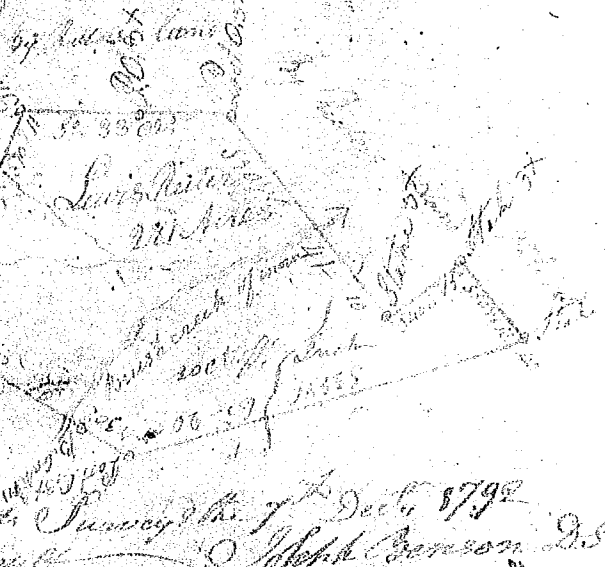

State of S. Carolina, Pursuant to a warrant from John Thomas Esq. Comr. of locatns N. Saluda, dated 29th Jan'y 1799, I have admeasured and laid out unto Salomon Kemp a tract of forty five acres of land in Greenville County S. side of river on a branch called Kemp's branch, walters of Saluda river bounded by a line running S.W. & N.W. by land laid out for Salomon Kemp, N.E. by land laid out for John Neill, S.W. Henry Benders land S. by Conner's land, and hath such shape form and marks as the above plat represents,

