

South Carolina Pursuant to a warrant from John Thomas Esq. C. L. of Saluda. Dated the 20. Sept. 1792. I have admeasured & laid out unto Robert Goodgion a tract of One Hundred & thirty seven acres of land situated in Washington District on the N. E. side of the Catawba River in Greenville County. Bounded by lines commencing N. 8. E. by John McNeely and all other sides vacant & hath such farm & marks as the above plat represents Surveyed the 20. Oct. 1792

W. D. Thomas D.
Recorded the 21. Dec. 1792

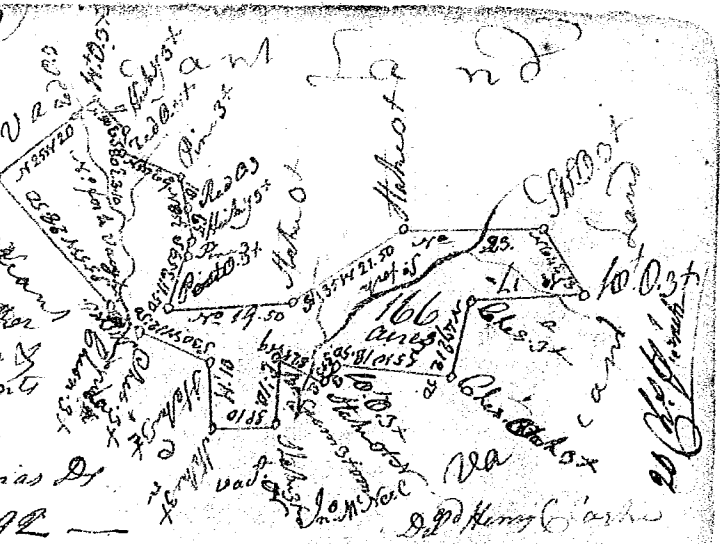

State of South Carolina Pursuant to a warrant from John Thomas Esq. C. L. of Saluda. Dated the 21. day of Dec. 1792. I have admeasured & laid out unto Robert Goodgion a tract of Eight Hundred and Thirty Seven acres of land situated in Washington District on a branch of Middle Sugar River. Bounded by lines commencing N. 8. E. by the said Robert Goodgion's land S. E. by James Bates & by John Spanns. S. E. by the ancient boundary line, all other sides vacant & hath such farm & marks as the above plat represents Surveyed the 22. Dec. 1792

W. D. Thomas D.
Recorded the 24. Dec. 1792



South Carolina Pursuant to a warrant from John Thomas Esq. C. L. of Saluda. Dated the 20. Dec. 1792. I have admeasured & laid out unto Absolom Stokes a tract of Two Hundred & twenty four acres of land situated in Pinckney District & Spartanburg County on both sides of the N. Fork of Sugar River. Bounded to the N. on Heath's land by a line running S 51 W 65.5 E to the N. on Browns and Nesbitt's lands by a line running thence N 39 W 46.50 to the N. on land laid out unto Wm Ford, by a line running thence N 81 E 55.35 to the N. E. on James Jordan Esq. S 51 E 46.70 & hath such shape & marks as the above plat represents Surveyed the 21. Dec. 1792

John Young Junr, D. S.
Recorded the 27. Dec. 1792

