

South Carolina - Pursuant to a Warrant from John Thomas Esq. Comm. Saluda, to the N. Saluda - Dated the 2<sup>d</sup> May 1792. To me assigned, I have measured & laid out unto John Reed a tract of land containing three hundred and eighty acres. Lying in Greenville County 4<sup>th</sup> on Saluda River. Bounded West by Mr. Kell's, Cook's land, N. by N. Ely land Original land Originally granted to Miles Jennings. E. & S. by Joseph & Reeds & Duncy's, Mountland's & W. by land Originally granted to John Martin & hath such shape and marks as the above Plat represents.

Surveyed the 5<sup>th</sup> May 1792

James Harrison D.S.

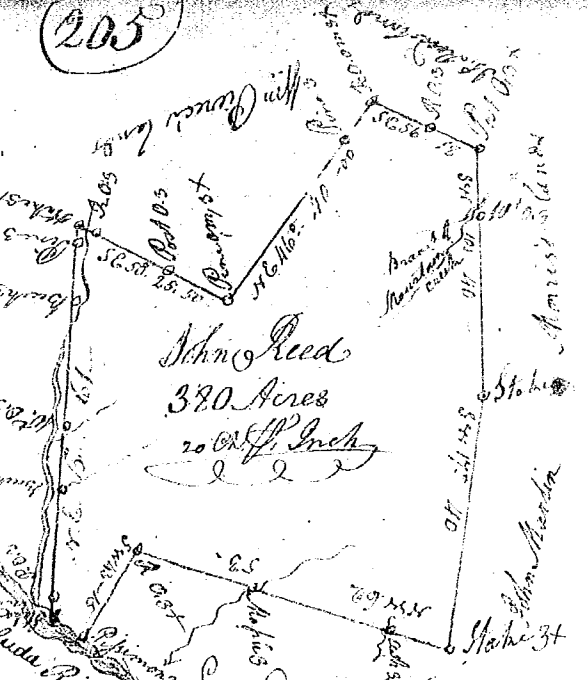

Recorded the 9<sup>th</sup> July 1792

South Carolina - Pursuant to a warrant from John Thomas Esq. Com. for the N. Saluda in the District. Dated the 2<sup>d</sup> May 1792. I have measured & laid out unto John Reed a tract of land containing two hundred & seventy acres, lying in Greenville County, on Mountain Creek of Saluda River. Bounded West by Bulls land N. & N. Ely old lines not known, S. & S. W. by Ann Brown and Geo. Martin's lands, & hath such shape and marks as the above plat represents.

Surveyed the 5<sup>th</sup> May 1792

James Harrison D.S.



Recorded the 9<sup>th</sup> July 1792

South Carolina - Pursuant to a warrant from John Thomas Esq. Com. of Saluda in the 9<sup>th</sup> District N. Saluda dated 9<sup>th</sup> July 1792. I have measured and laid out unto James Hollans a tract of 200 acres of land in the County as a soldier in the service of this, in said District on a branch of Buck-horn Creek & branches of Mountain Creek waters of Enoree river bounded by Lines running S. E. & S. E. on land William Wharton's all the sides with lands and hath such form and marks as the above Plat represents.

Surveyed 9<sup>th</sup> July 1792

Recorded 10<sup>th</sup> July 1792, J. P. Self

W. D. Thomas D.S.

