

(185)
 State of S. Carolina Pursuant to a warrant from
 John Thomas Esq. Com. Dated the 29th Decr.
 1791. I have admeasured & laid out unto Charles
 Moore a tract of Eighty One Acres of land situate
 in Spartanburgh County, on the N. side of Sugar
 Creek & on both sides Wardes Creek. Bounded to the
 N. by John Parkers land & to the S. by vacant land &
 Andrew Thomasons land & to the E. by Charles Moores, I shall
 such form & marks as the above plat represents.
 Surveyed the 28th Jan^y 1792 And Thomson Esq.
 Recorded the 29th of March 1792 Ed. Tho. Moore Esq.

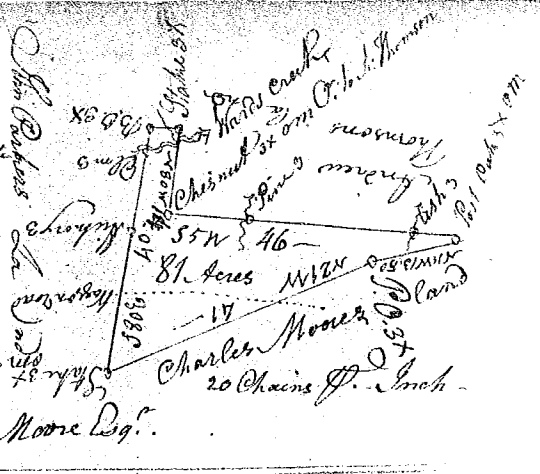

State of S. Carolina
 Pursuant to a warrant from John Thomas
 Esq. Com. Dated the 5th Feb^r 1791. I have admeasured & laid out
 unto Barnet Demsey a tract of four hundred
 & twenty five acres of land, situate in a district
 on Adams creek of Ince River, in S. Carolina
 with Hugh Hanagans land & to the S. with Williams
 & to the N. with an old line & Barnet Demseys & Lushbarts
 lands on other sides vacant & hath such form, and
 marks as the above plat represents.
 Surveyed the 6th Oct^r 1791 James Spford Esq.
 Recorded the 13th April 1792

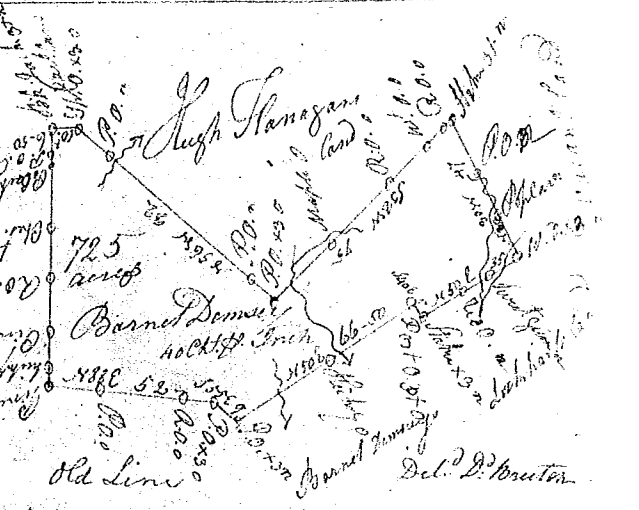

South Carolina Pursuant to a warrant from
 John Thomas Esq. Com. of locations for 96 Acre
 & Saluda Dated 11th Feb^r 1792. I have Circled
 I have Measured and laid out unto Lewis
 Wells a tract of land containing one hundred
 and twenty five acres, lying in Greenville
 County on the branches of Rocky Creek waters
 of Keelys river, bounded by a line running
 S 50 E 15 1/2 by Saphiel Hendersons land
 N 85 E by Robert Morrises land
 N 35 W by Elisha Nelsons land S 40 W
 by the said Lewis Wells land,
 and hath such shape form &
 marks as the above Plat represents.
 - sent Survey. 1st March 1792,
 James Harrison Esq.
 Recorded 1st April 1792 Del. Wm. Lucy



State of S. Carolina Pursuant to a warrant from
 John Thomas Esq. Com. Dated the 8th Feb^r 1792. I have
 Benjamin Griffith a tract of land containing
 200 Acres, situate in Greenville County
 on both sides of Lewis creek of Keelys
 river, bounded N. by S. on James Seaborn
 land & to the S. by vacant land, & to the E. by
 James Seaborn land & to the W. by James
 Griffiths land, & hath such
 shape form & marks as the above represents.
 Surveyed the 20th Feb^r 1792
 Recorded the 25th April 1792

