

State of Carolina / Pursuant to a warrant from John Thomas Comr. of loc. 96 District of Saluda dated 2^d April 1791, I have admeasured and laid out unto John Rodgers a tract of three hundred and thirteen acres of land in said District by Quirens County on Beards fork of Dumoreys Creek waters of Enoree river, bounded by a line 280 w 18 ch, S 62 w 10, ch, N 40 w 28 ch, 50, 40 w 71 ch, on Andrew Rodgers land & by lines N 47 w 32 ch, E 2: ch, N 45 E 40, on Allen Murrays land & by lines N 17 E 16 ch, N 40 E 45, on vacant land & land unknown and by lines S 17 E Part on land unknown & Part on David Gordings land, and hath such shape form and Marks as the above Plat represents, —
 Recorded 2^d May 1791 Del. ~~Wright~~ Surveyed 3^d April 1791, John Hunter De.

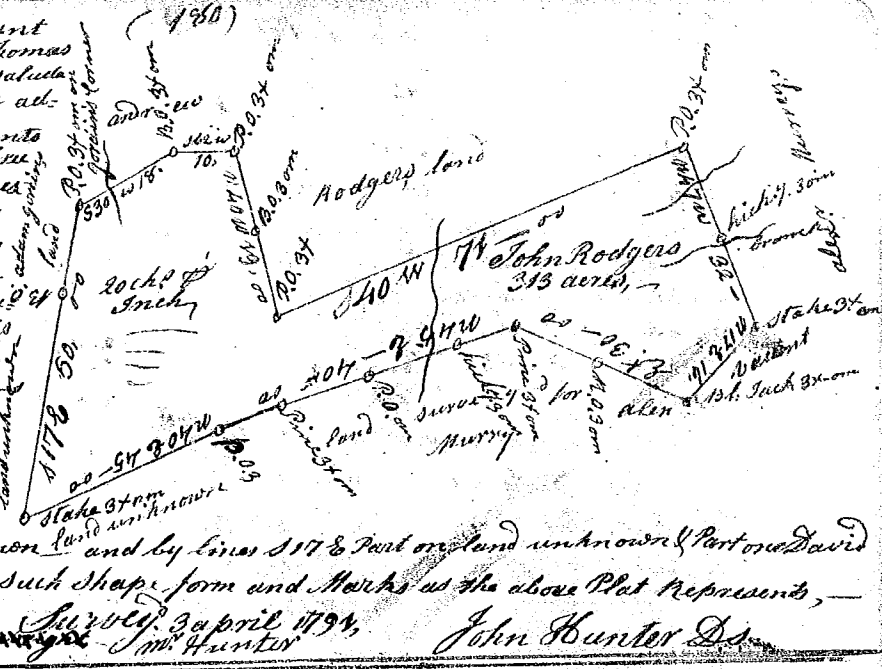

South Carolina, Pursuant to a warrant from John Thomas Esq. Comr. of loc. 96 District of Saluda dated 2^d April 1791 I have admeasured and laid out unto John Coker a tract of four hundred & eighty nine acres of land in said District on the little Beaver dam Creek waters of Enoree R. of the ancient boundary line, bounding on lines running Nward S 10, on land survey for Samuel Harby, by a line running N. 8 w. on land survey for W. Helms by lines running N. 45 w & N. 20, on land survey for John Young and Harry Bramlet, all other sides on unknown lands and vacant land and hath such form and Marks as the above Plat represents, —
 Recorded 3^d May 1791, Del. D. Wright — Surveyed 2^d April 1791, B. Arnold De.

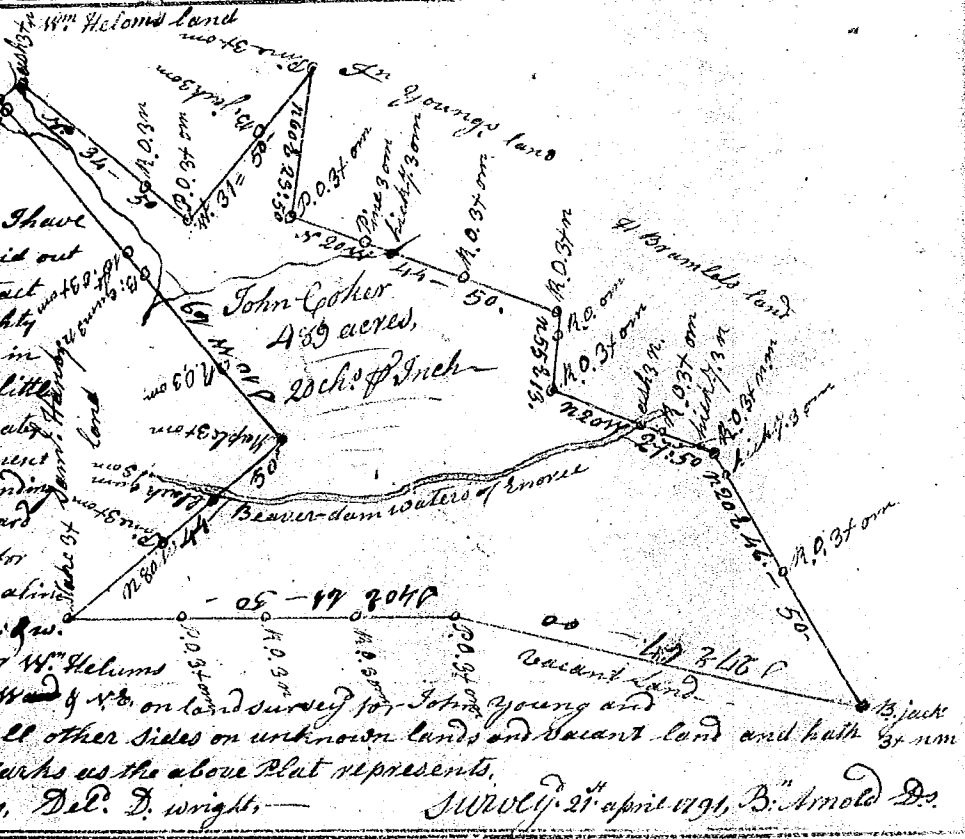

South Carolina, Ninety six District Pursuant to a warrant from John Thomas Esq. Comr. of Locations, S. C. Saluda river, I have admeasured and laid out unto John Moorhead Sr. a tract of one hundred acres of land in said District on the branches of Abitons Creek bounded S. by said Moorheads own land, E. by John Heringtons land and the other sides by vacant lands and hath such shape, form and Marks as the above Plat represents, Surveyed & Certified by me the 24th day of Juny 1791, Wm. Bae De.

