

State of S^c Carolina Pursuant to a warrant from John Thomas Esq^r Com^r of Locations dated 2^d Sept^r 1791, I have admeasured and laid out unto William Stringer a tract of two hundred acres of land in Ninety six District, Greenville County bounded by a line running S 59° W 7 chs thence S 36° W 9-50 thence S 70° W 35 chs on land laid out unto John Nadin on both sides of the N^e fork of Meils Mill Creek of the N^e fork of Saluda river, and hath such shape form and marks as the above plat represents,
 Recorded 29th Febr^y 1792. Del. self

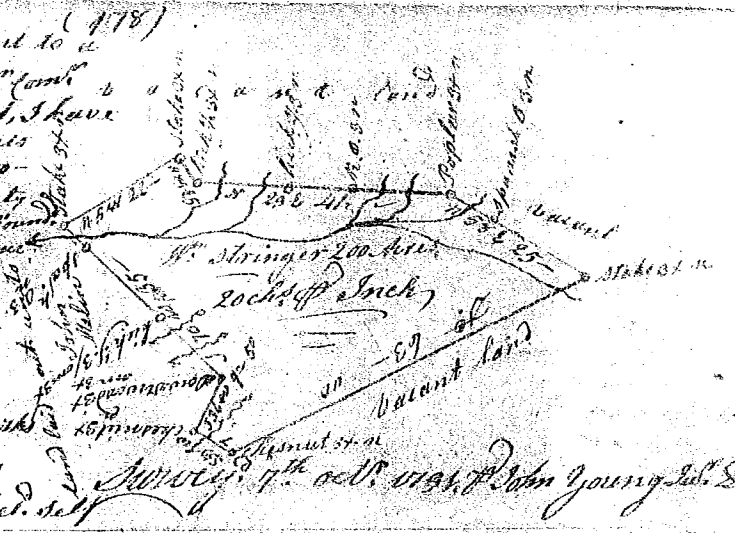

State S^c Carolina Pursuant to a warrant from John Thomas Esq^r Com^r in 96 District N^o of Saluda dated the 7th Sept^r 1791. I have admeasured & laid out unto William Ugray a tract of one hundred & sixty two acres of land, Situate in the said District, on Ferry's creek of Green river in Greenville County. Bounding by lines running N.E. & N.W. by land laid out for Joseph Terry all other sides vacant & hath such form & marks as the above plat represents.

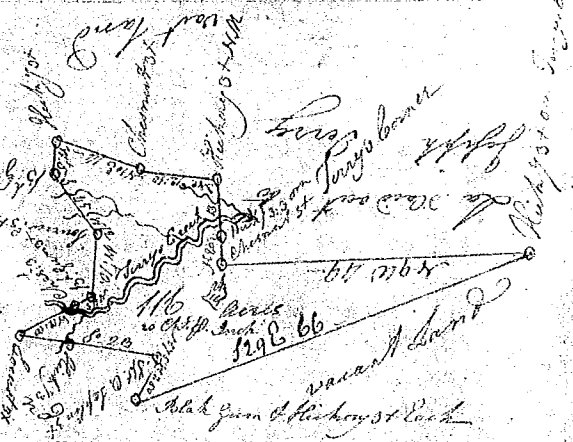

Done the 9th Sept^r 1791
 John Thomas Esq^r

Recorded the 19th April 1792

Pursuant to a warrant from John Thomas Esq^r Com^r in 96 District N^o of Saluda dated the 7th Sept^r 1791. I have admeasured & laid out unto William Ugray a tract of one hundred & sixty acres of land. Situate in S^c District on Ugray's branch of Green river in Greenville County. Bounding by a line running N.W. by a land laid out to Joseph Terry all other sides vacant & hath such form & marks as the above plat represents. Done the 9th Sept^r 1791

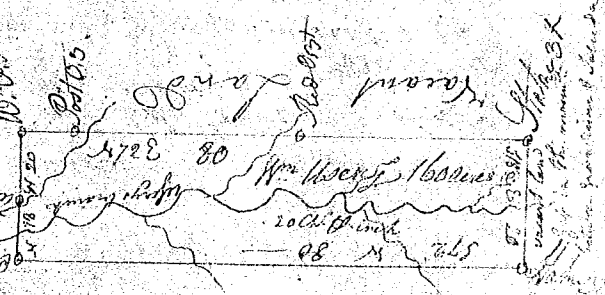

Recorded the 12th April 1792

John Thomas Esq^r Del. self

State of S^c Carolina Pursuant to a warrant from John Thomas Esq^r Com^r in 96 District N^o of Saluda. Dated the 28th Feb^y 1792. I have admeasured & laid out unto David Bruton a tract of twenty seven acres of land, Situate in said District, on the ridge near the waters of Ferguson's creek, waters of Sugar River running N.E. with D. Bruton Fourth George Bruton N.W. with Nazicks N.W. with Thomas Woodruff's Land, hath such shape & marks as the above plat represents.

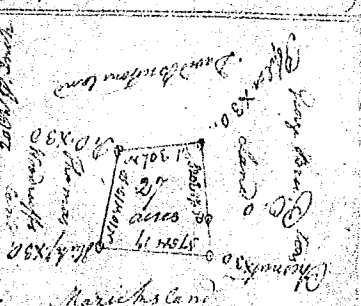

Done the 28th Feb^y 1792. James Wofford Esq^r Del. self

S^c Carolina Pursuant to a warrant from John Thomas Esq^r Com^r of Locations in 96 District N^o of Saluda. Dated the 8th Feb^y 1792. I have admeasured & laid out unto David Bruton a tract of twenty three acres of land, Situate in said District, on a branch of Ferguson's creek of Sugar River running N.W. with David Bruton East with John McCarly S.W. with George Bruton's land the other side vacant & hath such form & marks as the above plat represents.

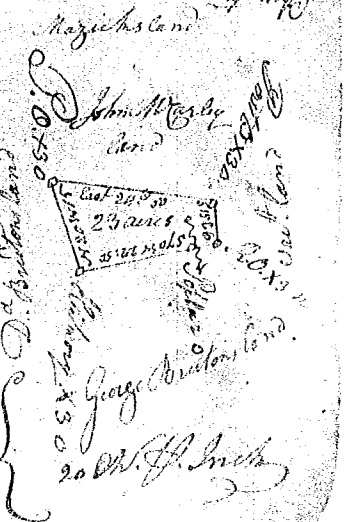

Done the 8th Feb^y 1792
 James Wofford Esq^r Del. self

Recorded the 13th April 1792