

State of Carolina Pursuant to a warrant from  
 John Thomas Esq. Commissioner of Locations  
 No. 1264 r. 107, I have measured and laid  
 out unto Benjamin Polgore within a tract of  
 469 acres of land in Northburg County  
 on the N. E. side of Long Run. bounded N. E. by  
 James Daniel land to the N. of Henry Wood  
 & Charles Blair, crossing the river to Thomas C.  
 & John Blair, said line eastward till it crosses  
 the river, then down the river to the first station  
 and to the south town & marks as the above  
 plat represents.  
 Surveyed the 18<sup>th</sup> Decr 1791.



Surveyed by  
 Vardner W. Bie Esq.

Recorded the 25<sup>th</sup> day  
 of Feb<sup>r</sup> 1792

Old Indian Boundary line

State of Carolina Pursuant to a warrant from  
 John Thomas Esq. Commissioner of Locations  
 No. 1264 r. 107, I have measured and laid  
 out unto Charles Petrick a tract of three  
 hundred acres of land, bounded N. E.  
 by Peterson's land, on the waters of  
 Abingtons creek, in Union County on  
 the N. E. side of broad river, and hath such  
 shape form & marks as the above  
 Plat represents, Surveyed by me the 3<sup>rd</sup>  
 Jan<sup>y</sup> 1792,  
 Vardner W. Bie Esq.  
 Recorded 21<sup>st</sup> February 1792

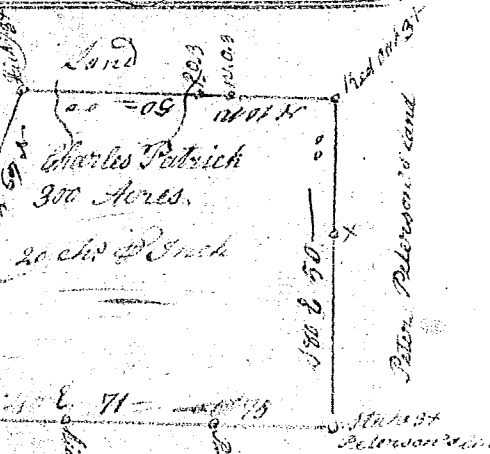

State of Carolina Pursuant to a warrant from  
 John Thomas Esq. Commissioner of Locations  
 No. 1264 r. 107, I have measured and laid  
 out unto David Peden a tract of three  
 hundred acres of land, bounded N. E.  
 by the former Indian land  
 & by land surveying  
 for David Peden all other  
 sides according to testimony  
 which the word acres & a  
 half such shape form &  
 marks as the above Plat  
 represents.  
 Surveyed 20<sup>th</sup> Jan<sup>y</sup> 1792  
 by James Harrison Esq.  
 Recorded 21<sup>st</sup> Feb<sup>r</sup> 1792

