

South Carolina Pursuant to a warrant from John Thomas Esq. Commissioner of loc^{ns} for the State of South Carolina dated 30th December 1791, I have measured and laid out unto James Powell a tract of land containing one hundred acres lying in Greenville County on the S^e side of Sandy river and branches of the same, bounded N^e & S^e by W^o Lees land N^e west by Sandermond land, N^eward by John Pyles land & S^eward by Thomas Sandford's land, and hath such shape and marks as the above Plat represents, Certified to Me this 14th Jan^y 1792. Jas. Harrison Esq. Recorded 23rd Jan^y 1792. Del. W. Peltard

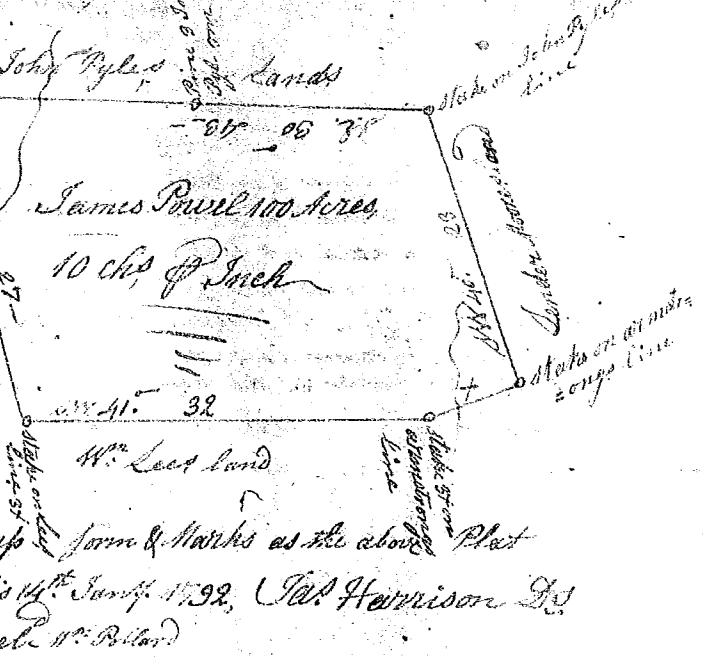

State of S^c Carolina Pursuant to a warrant from John Thomas Esq. Com^r of loc^{ns} in the 4th District of South Carolina dated 19th Oct^r 1791, I have measured and laid out unto Thomas Bridges a tract of three hundred and ten acres of land, Situate in the 4th District on Rocky Creek of Enoree River in Greenville County, bounding by a line running N 55° 45' E 248.50 & N 62° E by David Smith's land N 55° 45' E 248.50 & N 37° 15' E by land unknown & all other sides by vac^{ant} land and hath such form & marks as the above plat represents. Certified to Me this 19th Oct^r 1791. Jas. Harrison Esq. Recorded 26th Jan^y 1792. Del. Thomas

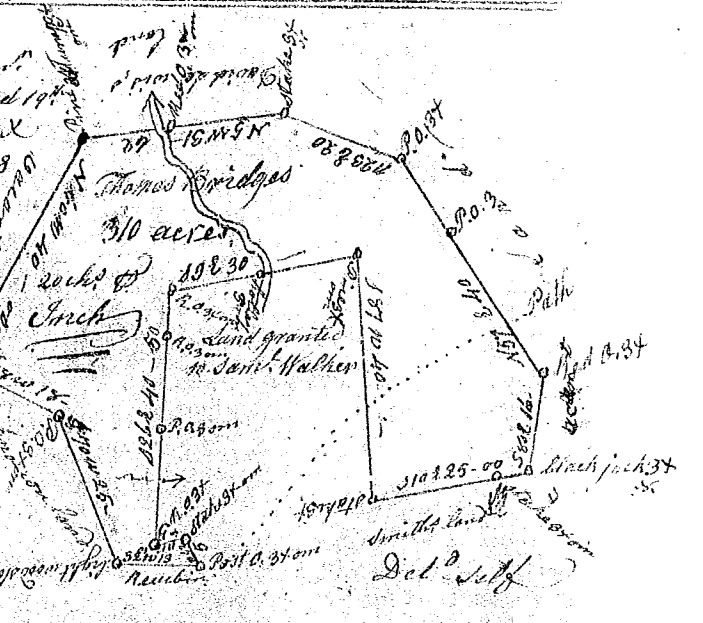

State of S^c Carolina Pursuant to a warrant from John Thomas Esq. Commissioner of locations dated the 25th day of Jan^y 1792, I have measured and laid out unto William Crow a tract one hundred and twelve acres of land in Greenville County on the small branches of Thomas's & Sandermond's land, bounded S^e by Michael Walling's land, N^e by Joseph H^e Cole's land N^e by Edward Watson's land, all other sides by vacant land, and hath such shape and marks as the above Plat represents. Certified to Me this 27th Jan^y 1792. Jas. Harrison Esq. Recorded 27th Jan^y 1792. Del. Self

