

State of S^c Carolina, Pursuant to a warrant from John Thomas Esq. Com^r of loc^s Dated 7th Sept^r 1791, I have admeasured and laid out unto James Henderson a tract of one hundred & seventy acres of land situate in 96 District Greenville County on both sides of the N^o fork of Musk-Creek waters of Tygar river; Bounded N^o by lands laid out out unto Bayles Earle Esq. & by land late out unto John Nicols, & on warrent land, & on vacant land, and hath such shape form & marks as the above Plat represents.

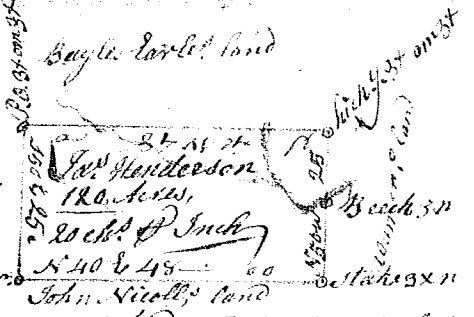

Recorded 28th Sept^r 1791, Del. self

Surveyed 24th Sept^r 1791, John Young Esq. D^o

State of S^c Carolina, Pursuant to a warrant from John Thomas Esq. Com^r of loc^s dated 7th Sept^r 1791, I have admeasured and laid out unto James Henderson a tract of one hundred and sixty acres of land in Ninety six District on both sides of the - Inman's Creek waters of the N^o fork of Saluda river, bounded by a line running N 30 W, on M. Jenkins, all other sides on vacant lands and hath such shape form and marks as the above Plat represents, Surveyed 28th Sept^r 1791.



Recorded 28th Sept^r 1791, Del. self

Surveyed 28th Sept^r 1791, John Young Esq. D^o

State of S^c Carolina, Pursuant to a warrant from John Thomas Esq. Com^r of loc^s dated the 17th Sept^r 1791, I have admeasured by laid out unto James Henderson a tract of one hundred acres of land, in 96 District, in Greenville County on two small branches of Musk-Creek waters of Beaver-dam-Creek of Saluda river bounded N^o on Modye land N on Miss Esther Thomas land N.W. on George Salmon's land S^o on lands said to be laid out for Robert Prince, and hath such shape, form & marks as the above Plat represents. Recorded 28th Sept^r 1791, Del. self.

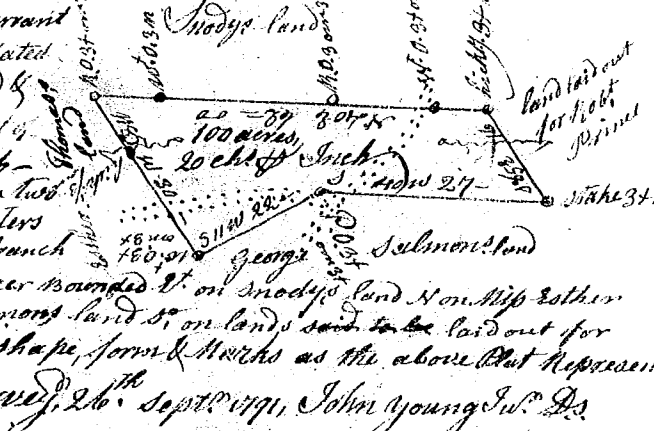

Recorded 28th Sept^r 1791, Del. self

Surveyed 28th Sept^r 1791, John Young Esq. D^o

State of S^c Carolina

WARRANT to

Warrant from John Thomas Esq. Com^r of Locations, I have admeasured & laid out unto Nicholas Jasper, a tract of two hundred & forty acres, land - Situate in 96 District, on the S^o side of Broad river on the branches of Peeble river: & hath such shape form & marks - Bounding & Dutting as the above plat represents. Surveyed the 25th July 1791.

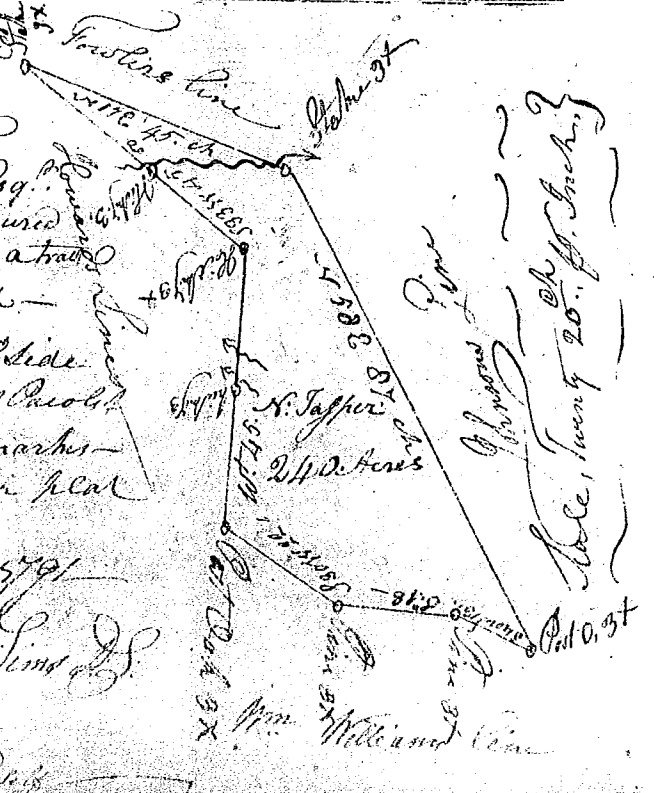

Surveyed the 25th July 1791.
Charles Lind D^o
Recorded 5th October 1791.