

State of S. Carolina,

Pursuant to a warrant from John Thomas Esq. Com. of the Court dated 25. Aug. 1791. I have admeasured and laid out unto George West a tract of four hundred & twenty five acres of land in 96 District, Spartanburg County on three small branches of Lawson's fork of Pacolet river, bounded W. on D. George West's & Elizabeth Lewis's lands, S.E. on James Burnet's land, E. on Smith's land, all other sides on vacant land, and hath such shape, form & marks as the above Plat represents.

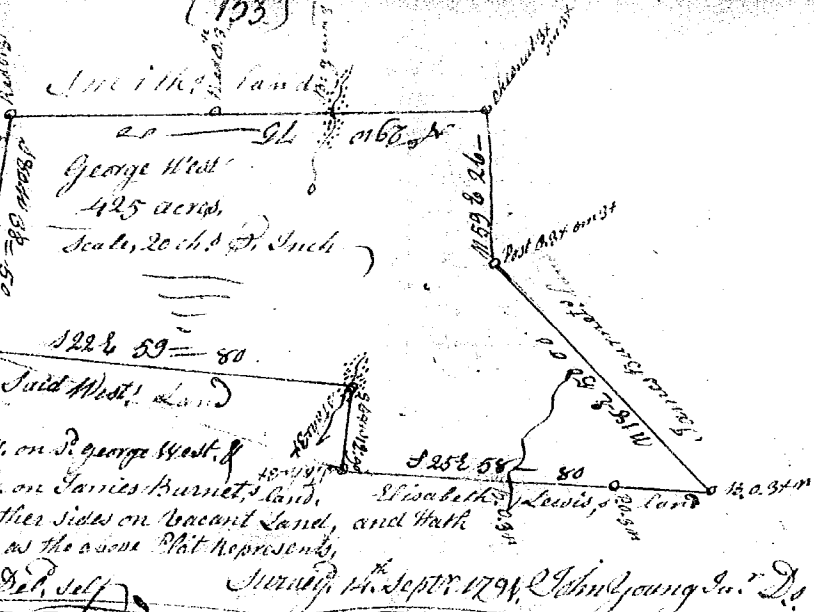

Recorded 15th Sept. 1791. J. Young Esq. D.

Surveyed 14th Sept. 1791. John Young Esq. D.

State of South Carolina Pursuant to a warrant from John Thomas Esquire, Com. in 96 District re. of Survey. Dated the 27th March 1792. I have admeasured & laid out unto Jesse Carter a tract of land containing seventy & one acre, situate in the said District on the branches S. side of Sandy River, bounding by a line 1/2 mi. by land Survey for Jacob D. Rice, S.E. on the land of Charles Land, S.W. by land Survey for Jacob D. Rice, & hath such shape, form & marks as the above plat represents.

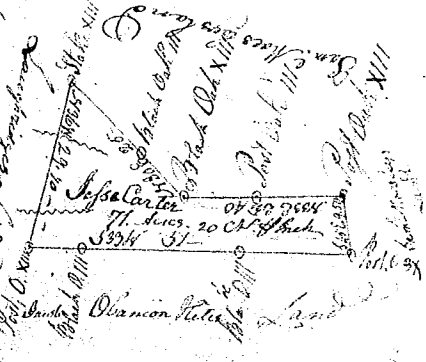

Recorded the 14th June 1792. Joseph Benson Esq. J. C. L.

Ignatius Griffin

1000 Acres

Surveyed 14th to an inch

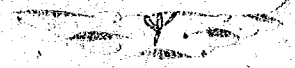

State of S. Carolina

Pursuant to a warrant from John Thomas Esquire, Com. in 96 District re. of Survey. Dated the 14th day of June 1792. I have admeasured & laid out unto Ignatius Griffin a tract of 1000 acres of land in 96 District, Spartanburg County, on the waters of Sandy River, bounded by a line 1/2 mi. by land Survey for Jacob D. Rice, S.E. on the land of Charles Land, S.W. by land Survey for Jacob D. Rice, & hath such shape, form & marks as the above plat represents.

Surveyed 14th day of June 1792

Recorded the 21st November 1792

Recorded the 21st November 1792