

State of S<sup>c</sup> Carolina,  
 96 district, Pursuant to a  
 warrant from John Thomas  
 Esq. Commissioner of Land,  
 dated 3<sup>rd</sup> Feb<sup>y</sup> 1791, I have  
 admeasured and laid out  
 unto Rowland Jennings a  
 tract of four hundred and fifty  
 six acres of land, in part  
 =burg County on small branches  
 of Dutchmans Creek and fair forest, Bounded  
 so by Daniel Stephens, and D. Jennings and  
 Daniel Barnetts lands, N.E. by Fredric Woods land  
 N & W. by Richard Hamptons land, and hath  
 such other shape and marks as the above Plat  
 represents, Surveyed 3<sup>rd</sup> March 1791,  
 Andrew Thomson, D<sup>y</sup>.

Recorded 6<sup>th</sup> May 1791, —

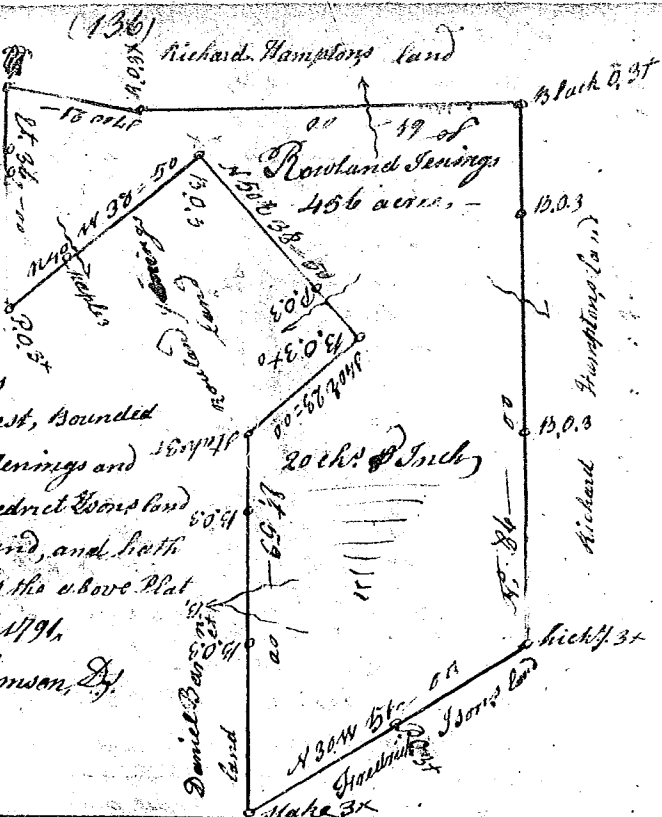

State of S<sup>c</sup> Carolina Pursuant to a  
 warrant from John Thomas Esq. Com<sup>r</sup>  
 of Loc<sup>ty</sup> 96 District N. Saluda dated  
 18<sup>th</sup> April 1791, I have admeasured  
 and laid out unto James Wofford a  
 tract of 327 acres of land in said Dist<sup>ct</sup>  
 on the branches of Durbins Creek waters  
 of Enoree river bounding S.W. with  
 Robert Willsons land N. N. & S.W. with  
 William Gists land, all other sides  
 by vacant lands, and hath such shape  
 and marks as the above Plat represent.  
 Surveyed 19<sup>th</sup> April 1791, James Wofford D<sup>y</sup>.  
 Recorded 9<sup>th</sup> May 1791, Del. Stone

State of S<sup>c</sup> Carolina Pursuant to a warrant from  
 John Thomas Esq. Com<sup>r</sup> of Loc<sup>ty</sup> 96 Dist<sup>ct</sup> S. Saluda, dated  
 18<sup>th</sup> April 1791, I have admeasured and  
 laid out unto James Wofford a tract of  
 202 acres of land, in said  
 District on the branches of  
 Rabonys Creek waters of Muddy  
 River, bounding S.W. & S. by John  
 Howards land, N.W. & N.E. with  
 Hendersons land, S.E. with Saml.  
 Cobbs land, all other sides vac<sup>ant</sup>  
 land, and hath such shape &  
 marks as the above Plat represent.  
 Surveyed 19<sup>th</sup> April 1791, James Wofford D<sup>y</sup>.

