

State of South Carolina (129)
 Pursuant to a warrant from John Thomas Esq.
 Commissioner of Locations dated 10th July 1790 -
 I have admeasured and laid out
 unto John F. Wolff a tract
 of five hundred and seventy
 seven acres of land in
 Laurens County 96th Dist. 50th 30th
 N.W. side of Snow river
 on the branches of lower
 - fork of Darbins creek
 N. and S. on lands unknown
 all other sides on vacant
 land, and hath such shape
 marks, settings and town
 - drings as the above Plat
 Represents Survey 2th Aug. 1790
 Recorded 25th March 1794, Del. Cambridge by John Thomas Esq.

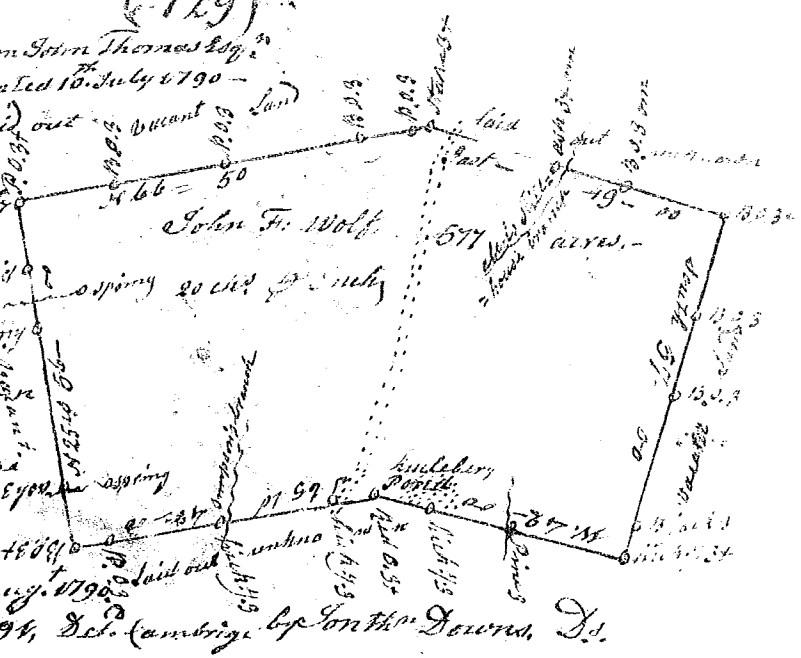

State of S. Carolina Pursuant to a warrant from
 John Thomas Esq. Comr of Locations 96th District
 of Saluda, Dated the 11th day of Janry. 1791 -
 I have admeasured and laid out unto
 Philemon Harvey a tract of thirty seven
 acres of land, in 96th District, Laurens County
 waters of Beard's fork waters of Duncan's
 Creek, bounded by a line running N. 45 E -
 29: 30. on land whereon David Shoultard, 17th
 by a line running S. 82 W 29: 77 on large survey & by a line S 80 W 5: 50 - on
 vacant land & by a line N 23 34 24: 30. on large survey, and hath such
 shape form and marks as the above Plat Represents, Survey 13th Janry 1791
 1791, by John Hunter Esq.
 Recorded 11th April 1794, - Del. Self.

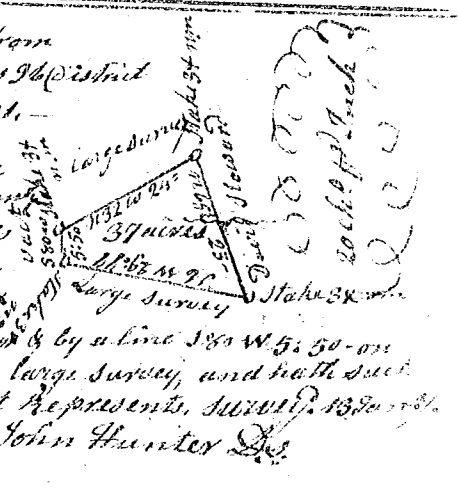

South Carolina Pursuant to a warrant from John Thomas Esq.
 Comr of Locations N. Saluda Dated 8th April 1791, I have admeasured
 and laid out unto Samuel Murray a tract of seventy seven
 acres of land, in Newberry County 96th District on a small draft
 of the hunting fork of Indian Creek waters of Snow river
 bounded by a line running N. 88. by land survey for Hugh Lawler
 = det. by a line running S. 84. by land survey for W. M. Cook, 20th 20th
 by lines N. E. N. E. & N. E. by land survey. Samuel Murray, and
 hath such shape and marks as the above Plat Represents. Survey 8th April 1791.
 Recorded 11th April 1791. Del. Self, A. Pearson Esq.

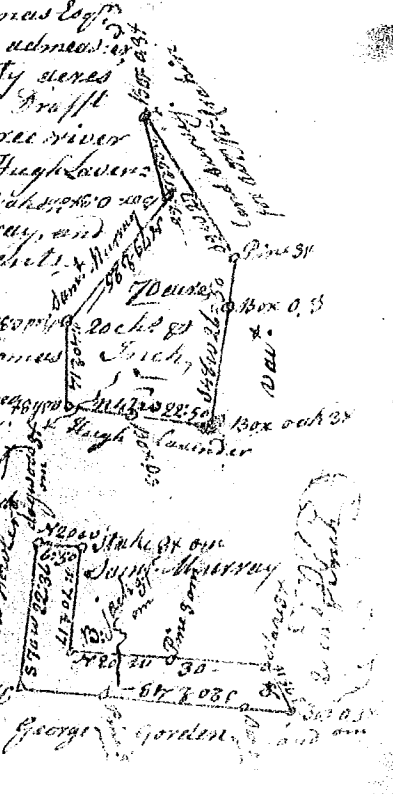

South Carolina Pursuant to a warrant from John Thomas Esq.
 Comr of Loc^{ns} N. Saluda Dated 8th April 1791, I have admeasured
 = surveyed and laid out unto Samuel Murray a tract of
 Thirty Eight acres of land in Newberry County 96th Dist.
 on a small Draft running into the hunting fork of Indian
 Creek waters of Snow, bounded by a line running
 S 20 E. by land survey for George Gordon, by a line S 40 E
 by widow Fowler. N 20 W. N 70 E. & N 20 W by Samuel
 Murray's land, and hath such shape and marks
 as the above Plat Represents, Survey 8th April 1791.
 Recorded 11th April 1791, Del. Self.
 A. Pearson Esq.