

South Carolina Pursuant to a warrant (125)
 Laurens County from John Thomas Esq. Comr. of locations
 Dated 10th Decr. 1790, I have admeasured and laid
 out unto William Andersons a tract of Two hundred and
 fifteen acres of land on the waters of
 Reberns Creek, bounding W on land of John Blackwell
 & Pincors S on Samuel Scott E on Benjamin
 & William Morris; and hath such shape
 form and Marks as the above Plat
 represents. Survey, 1st Jan'y 1791
 John Rodgers Esq.

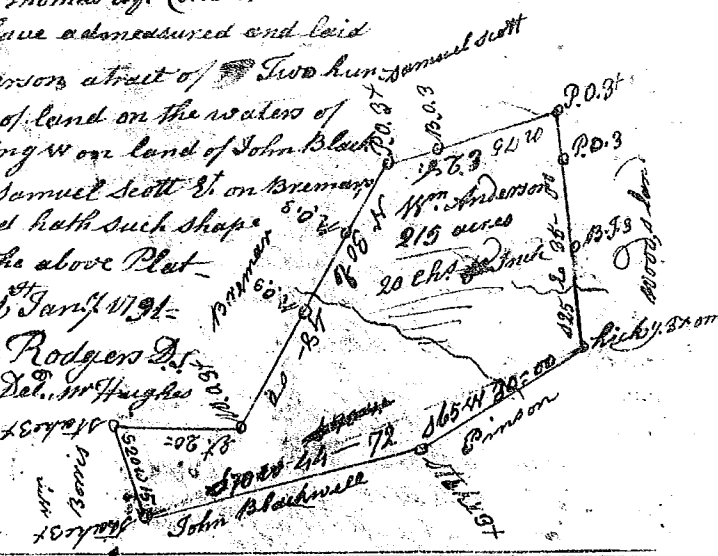

Recorded 25th March 1791, Del. W. Hughes

Pursuant to a warrant from
 John Thomas Esq. Comr. of locations
 of locations 96 District N.
 Saluda I have laid out
 and admeasured
 unto Joshua
 Petit & John
 Hembie a tract
 of land lying
 on the N side of
 Pacolata river
 opposit the Healing
 Spring, and hath
 such shape and
 bounds as the
 above Plat represents
 Certified for this 15th day of Nov. 1788,
 Recorded the 23rd March 1791, for John Gray
 Jas. Smith Esq.



South Carolina Pursuant to a warrant from John Thomas Esq. Comr. of locations
 Laurens County 5th District Saluda added 11th february 1791, I have admeasured
 and laid out unto Moses Pincors a tract of one hundred and
 ninety acres, on the branches of Reberns creek, bounding S on
 Joseph Pincors, S.W. on Archibald M. Donald, W. on Boyd E. on
 Caldwell's land, and hath such shape, form and Marks as of
 above Plat represents. Survey, 18th febr'y 1791
 Recorded 2nd March 1791, Del. J. Selt
 John Rodgers Esq.

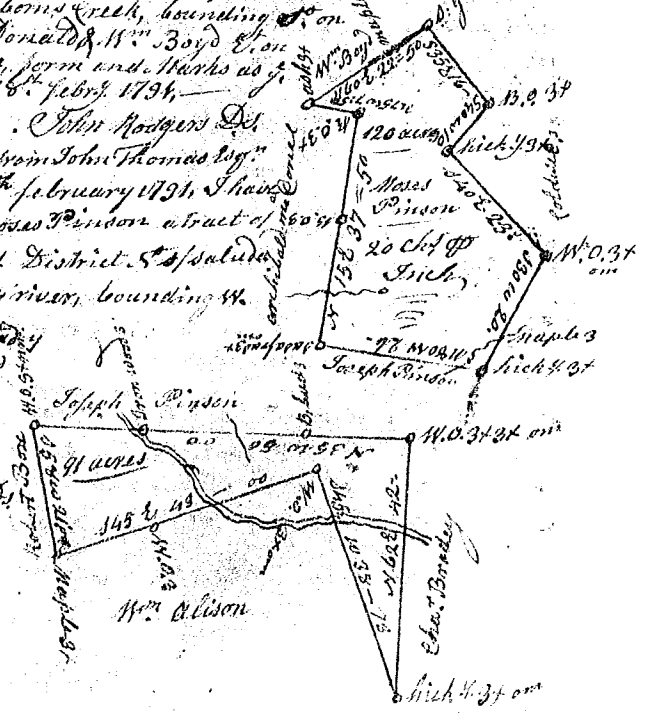

South Carolina Pursuant to a warrant from John Thomas Esq.
 Laurens County 5th District of loc. Dated 11th february 1791, I have
 admeasured and laid out unto Moses Pincors a tract of
 ninety one acres of land, in said District 5th Saluda
 on the Reberns Creek waters of the Saluda river, bounding W.
 on William Alison Esq. S on Ch. Bradley
 E. Joseph Pincors, N on Robt. Cox, and
 hath such shape form, and Marks
 as the above Plat represents,
 Survey, 5th March 1791
 John Rodgers Esq.
 Recorded 25th March 1791
 Del. Selt

