

South Carolina Pursuant to a warrant (62)
 from John Thomas Esq. Comr. of locations
 in the District of the 1st July 1788, I have
 admeasured and laid out unto Hugh ...
 a tract of one hundred & eighty two acres
 in said District on the waters of ...
 bounding by a line running S. 6. by land
 survey for Jonathan Parker, by a line
 running N. W. by land survey for Richard
 Powell, all other sides unknown lands
 and hath such form & marks as the
 above Plat represents. Survey'd 5th July 1788,
 Recorded 6th Jan'y 1789, Del. ~~Thomas~~ Dye

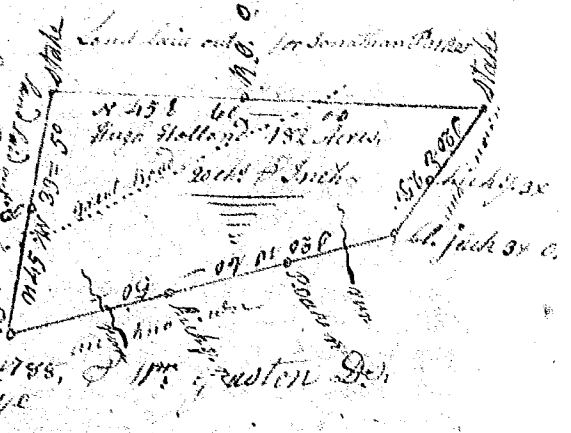

South Carolina Pursuant to a warrant from
 Laurens County - John Thomas Esq. Comr. of locs, I have
 admeasured and laid out unto Thomas Rogers a tract
 of one hundred & three acres of land on Mudlick -
 Creek, bounding S. by Anthony Goddins, S. W. on
 Mr. Drayton & Nathan Nicholas, and hath such shape and
 marks as the annexed Plat Represents, Survey'd 15th Decr 1788,
 Recorded 6th Jan'y 1789, Del. ~~Thomas~~ Dye

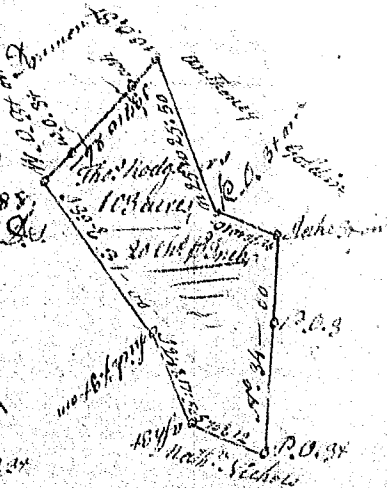

South Carolina Pursuant to a warrant
 Laurens County from John Thomas Esq.
 Comr. of locs. dated 4th Oct. 1788, I
 have admeasured and laid out unto
 Thomas Rogers a tract of 13 acres
 of land on the waters of Little
 river, bounding by a line running S. 6. on
 land held by Charles Campston, & by a line running S. 6. on land held by John
 Boyson, by a line running S. 6. on Boyson's land, a line running S. 6. on W. M. ...
 S. 6. on land claimed by John ... and hath such shape and
 marks as the above Plat Represents, Survey'd 3rd Novr 1788,
 Recorded 6th Jan'y 1789, Del. ~~Thomas~~ Dye

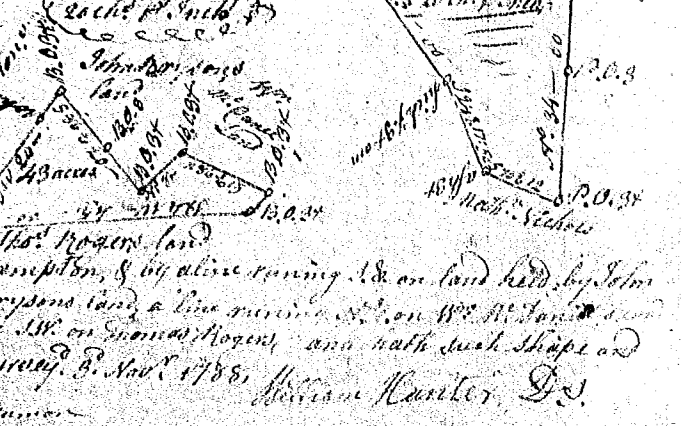

South Carolina Pursuant to a warrant from John
 Thomas Esq. Comr. of locs. in the District of the 1st Saluda
 have admeasured & laid out unto Joseph Caldwell
 a tract of 70 acres of land on the waters of Cannon's
 Creek, bounding by a line running S. 6. on Joseph
 Caldwell's land, & S. 6. on S. ... land, all other
 sides on ... land, laid out, & hath such marks
 as the above Plat represents. Survey'd 28th Novr 1788,
 Recorded 7th Jan'y 1789, Del. Jerry Dougherty, J. Dougherty D.



South Carolina Pursuant to a warrant from
 John Thomas Comr. of locations & Saluda
 I have admeasured and laid out unto John
 Davison a tract of ninety five acres of
 land on the waters of Second Creek, bounded
 by a line S. 6. on Ezeiel Beem & Alex. Johnston
 lands, N. W. on George Luber's land, S. W. & S. E. on
 Benj. Buchanans land, and hath such shape
 and marks as the above Plat represents,
 Survey'd 27th Novr 1788,
 Recorded 7th Jan'y 1789, -
 Del. Jerry Dougherty, J. Dougherty D.

