

Pursuant to a warrant from John Thomas Esq. Commissioner of Locations in No. 2 Saluda, I have measured and laid out unto Joshua Petty a tract of six hundred acres of land, the city creek, bounded 170 W 12 ch. on Samuel Shipps land, 117 W 20 ch. on vacant land, 495 E 14 ch. on vacant land, 170 E 50 ch. on Samuel Shipps land, 120 E 13 ch. on Thomas land, 164 E 42 ch. on Suchols land, N 20 E 21 ch. on David Robertson land, N 10 E 24 ch., 415 E 20 ch., N 20 W 15 ch. on James Robertson land, N 10 E 30 ch. on Jas. Robertson land, 180 W 40 ch. on vacant land, 110 W 80 ch. on Solomon Mangum land, 410 E 40 ch. on John Suchols land, 120 E 24 ch., 210 E 40 ch.; John Suchols land, and hath such shape & marks as the above Plat represents,

Survey, 17th Dec. 1786.
 Lach^r. Bulloch Esq.
 Recorded 17th Dec. 1788, Lach. Esq.

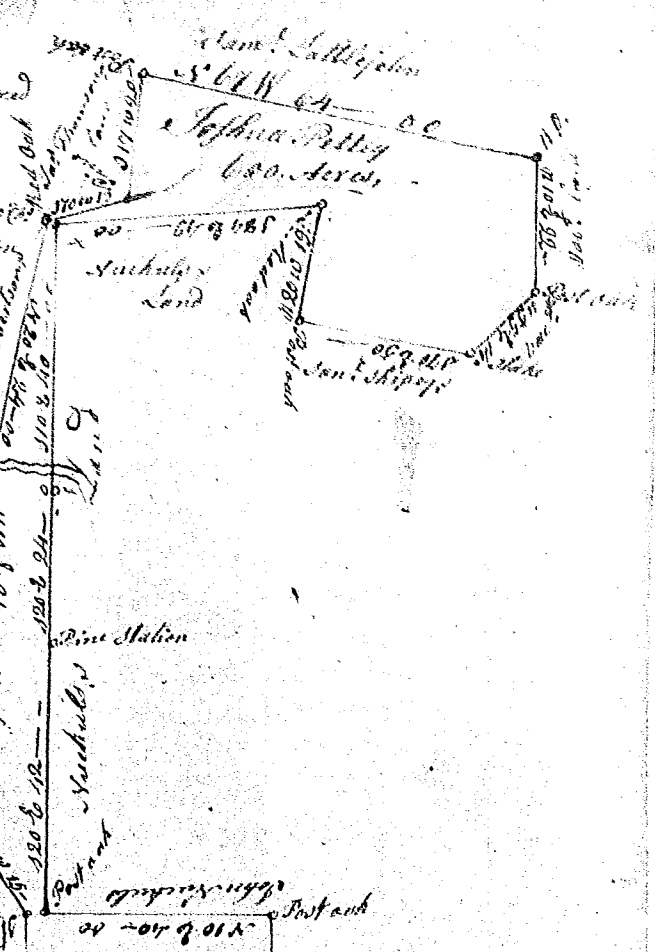

State of Carolina,

Pursuant to a warrant from John Thomas Esq. Comm. of loc. No. 2 Saluda, I have measured & laid out unto Solomon Bobs a tract of 315 acres of land on the S. side of the fork of Sugar Creek in Spartanburg County. Having such shape as the annexed Plat represents,

Survey, 16th Dec. 1788.
 Robt. Hemmick Esq.
 Recorded 22nd Dec. 1788,
 Robt. Esq.

