

State of S^c Carolina Pursuant to a warrant from John Thomas Esq^r Comm^r of locations Dated 21st May 1788. I have administered and laid out unto Thomas Blasingame a tract of one hundred & eighty nine acres of land, in Union County, S^c Side Saluda, on a small branch of Biminy Creek, situate of Sugar Hill, bounded W. by land survey for Benjⁿ Morrison, E. & S. by Joseph Little land, S. & W. by Bejel Whites land & Thomas present said, and hath such form and marks as the above Plat represents, recorded 23rd July 1788. Survey 22nd May 1788. Samuel Lancaster Esq^r. S^c Edm^d Hartin

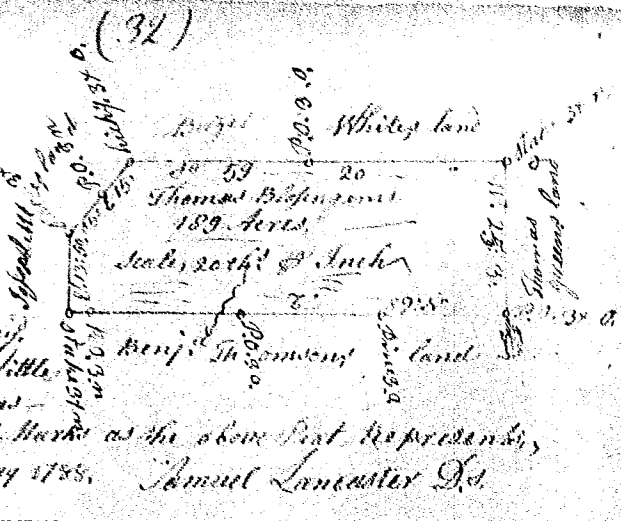

South Carolina Pursuant to a warrant from John Thomas Esq^r Comm^r of locations Dated 12th July 1788. I have administered and laid out unto Joseph Blackwood a tract of one hundred & eighty acres of land, in S^c Side Saluda river, bounded S. & S. Alex^r Copland S^c on road, land & vacant land, 2nd on road, land S^c on North Pacolat river, opposite to ant^y Milians land, and hath such shape form & marks as the above Plat represents, - Survey 24th July 1788. Recorded 29th July 1788. John Y. Self Esq^r.

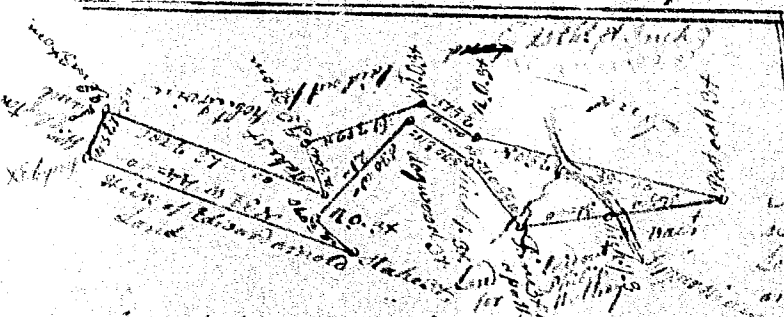

State of S^c Carolina Pursuant to a warrant from John Thomas Esq^r Comm^r of locations S^c Side Saluda, I have administered and laid out unto Thomas Sed a tract of one hundred & eighty five acres of land on Upper river in Spartanburg County, having such shape, marks, bearings & boundaries as the above Plat represents, Survey 2nd July 1788. Recorded 6th Augst 1788. S^c Edm^d Hartin Esq^r.

State of S^c Carolina Pursuant to a warrant from John Thomas Esq^r Comm^r of locations S^c Side Saluda, I have administered and laid out unto Thomas Sed a tract of thirty six acres of land on the S^c side of Enore river in Union County, having such shape, marks, bearings & boundaries as the above Plat represents, - Survey 25th July 1788. Recorded 1st Augst 1788. S^c Edm^d Hartin Esq^r.



S^c Carolina Pursuant to a warrant from John Thomas Esq^r Comm^r of locations dated 16th May 1788. I have administered & laid out unto William Duncan a tract of 19 acres of land in S^c District, on a branch of Upper river, situate of Sugar Hill, bounded S. by William Hendricks land, S. & W. by Duncan land, S. & W. by Thomas Sed land, and all other sides vacant land & hath such shape and marks as the above Plat represents. - Survey 13th May 1788. S^c Edm^d Hartin Esq^r. Recorded 8th June 1788. S^c Edm^d Hartin

