

State of South Carolina —
 Pursuant to a warrant from John Thomas Esq: Comr: of locations & Saluda, I have admeasured and laid out unto Isham Lafold a tract of 369 acres of land, on both sides of Island Creek waters of Pacolet river, bounded W. by Big Survey, all other sides on Vacant land, and hath such form and Marks as the above Plat represents,
 Survey, the 19th May 1788. —

Vardry M. Bee Esq:
 Recorded 19th June 1788. —

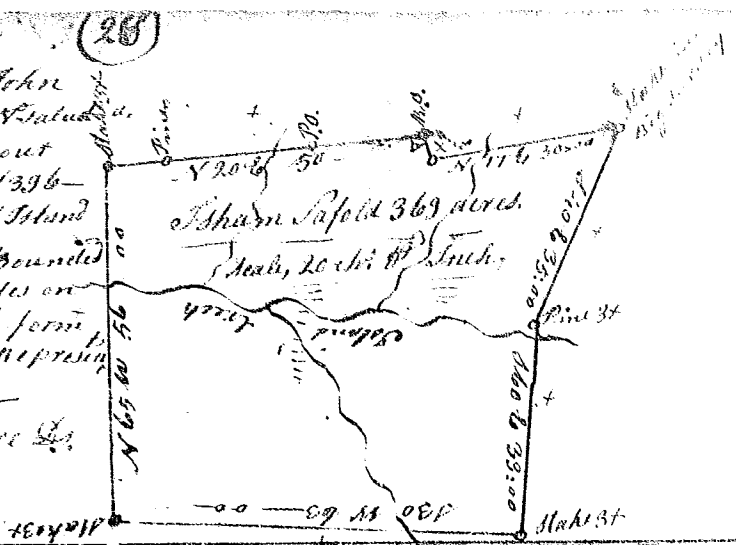

State of S^c Carolina Pursuant
 to a warrant from John Thomas Esq: Comr: of locations & Saluda, I have admeasured and laid out unto Cranshaw Camp a tract of five hundred & fifty five acres of land in 36th District, bounded S^c by land laid off for David Hopkins, all other sides by vacant land, and hath such shape and Marks as the above Plat represents,
 Survey, the 22nd May 1788. V. M. Bee Esq:
 Recorded 19th June 1788. —

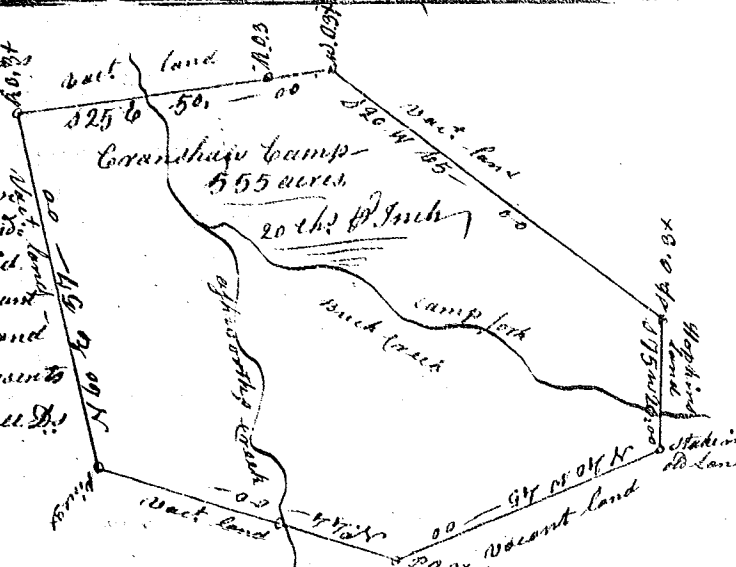

State of S^c Carolina Pursuant to a warrant from John Thomas Esq: Comr: of locations, & Saluda, I have admeasured and laid out unto Thomas Warren a tract of 29 acres of land in 36th District, on the branches of Pacolet, bounded W. by said Warren's land, S^c by vacant land, E. by Hightowers land & Morris's land, N^c by vacant land, — and hath such shape & Marks as the above Plat represents,
 Recorded 19th June 1788. —

Survey, the 29th May 1788. Vardry M. Bee Esq:
 Recorded 19th June 1788. —

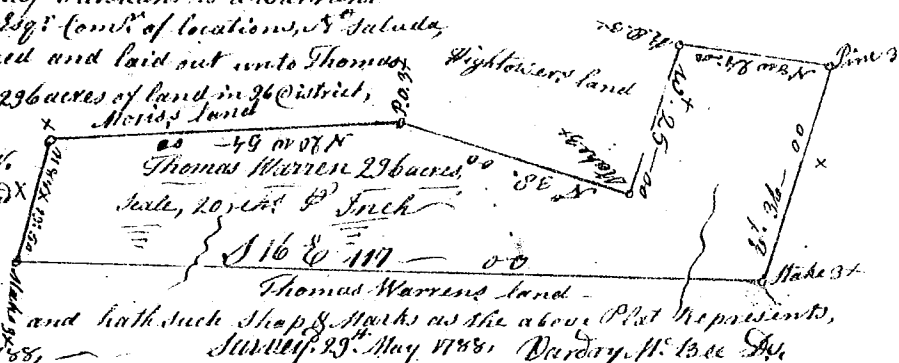

State of South Carolina Pursuant to a warrant from John Thomas, Comr: of locations & Saluda, I have admeasured and laid out unto Willis Watkins a tract of 200 acres of land on Buck Creek, waters of Pacolet river, bounded N^c by woods lands, all other sides vacant land, and hath such shape and Marks as the above Plat represents,
 Survey, the 17th May 1788.
 Recorded 19th June 1788. —

Vardry M. Bee Esq:
 Recorded 19th June 1788. —

