

(16)

State of South Carolina Pursuant to a warrant from John Thomas Esq. Comr. of loc^{ns}. Dated 6th Dec^r 1788, I have admeasured and laid out into Maronaduka lots a tract of one hundred acres of land, in 96 District on waters of Bush river and hath such shape Marks, Buttings & soundings as the above Plat represents. Subsd. 14th April 1788, Recorded 3rd May 1788, — J. S. Wright Esq.

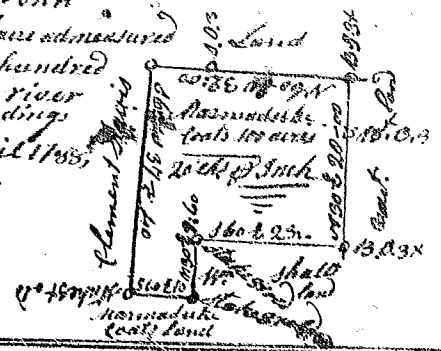

South Carolina Pursuant to a warrant from John Thomas Esq. Comr. of locations 96 District of Saluda, Dated 10th Dec^r 1787, I have admeasured and laid out into James Gray a tract of 250 acres of land, in Greenville County on Millcat Creek a branch of Sth Tyger River, and a branch of Upper Thompsons beaver dam Creek of Middle Tyger river bounding by lines running N. 88. 8. 4 W. by land survey for Samuel Thomas W. & S. by land of Ann Smith S.W. by land survey for Henry Brogdon, all other sides vacant lands, Rankin and and hath such shape & marks as the above Plat represents. Recorded 10th May 1788, Del. sub. — Survey 11th Dec^r 1787, W. L. Thomas Esq.

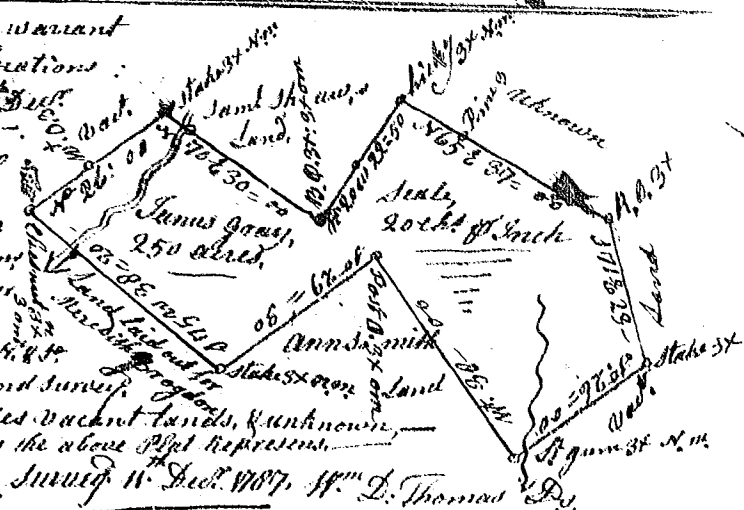

South Carolina Pursuant to a war^{nt} from John Thomas Esq. Comr. of loc^{ns}. Saluda dated 10th March 1788, I have admeasured and laid out into John Duncan a tract of 550 acres of land in Laurens County 96 District on upper Duncan Creek of Enoree bounded W. N. by land survey for John Odell & John Duncan & by vacant land of Joseph Duckett & Levi Casey N. by John Clark & John Duncan & Embrace Whitten W. by James Duncan and an Henry Davis, and hath such shape and marks as the above Plat represents. Survey 13th March 1788. A. Abel Pearson Esq. Recorded 10th May 1788, Del. sub.

