

State of Carolina
 Pursuant to a warrant from
 John Thomas Esq. Com. of
 Location, I have admeasured
 and laid out unto Hastings
 Diell, a tract of 425 acrs
 on the branches of Cayburn
 Creek and Ready-river, and
 hath such shape, marks and bound-
 ings as the above plat represents
 Surveyed the 10th April 1788
 Robert Hanna Esq.

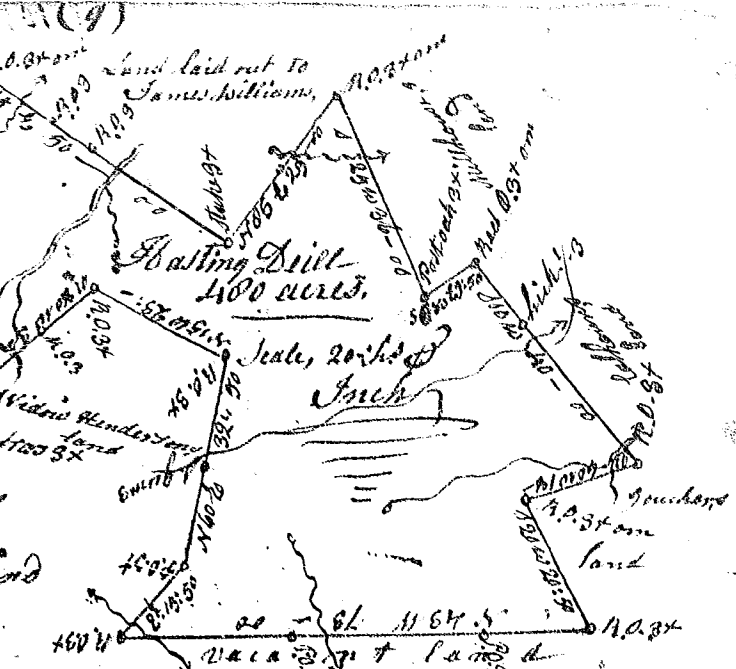

Recorded the 24th April 1788 and
 D.C. to Rich. Owens

State of Carolina Pursuant to
 warrant from John Thomas Com. of Location
 of Saluda, I have admeasured & laid out
 unto Hastings Diell a tract of 240 acres of
 land on Myborns Creek, in Laurens County
 having such shape, marks, cuttings &
 boundings as the above plat represents,
 Surveyed 9th April 1788,
 Recorded 25th April 1789, Rob^t Hanna Esq.
 Rich^d Owens

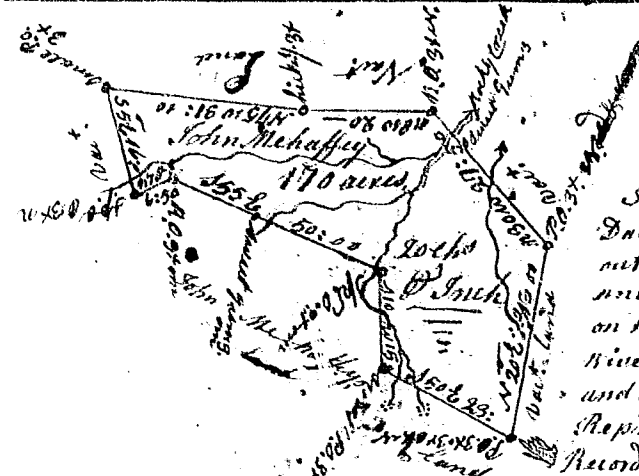

State of Carolina,
 Pursuant to a warrant from
 John Thomas Com. of Location 96 District of Saluda
 Dated 2^d June 1787, I have admeasured & laid
 out unto John Mehaffey a tract of one hundred
 and seventy acres of land, in 4th District
 on the south fork of Rocky Creek, a branch of Snow
 River in Greenville County, and hath such form
 and marks, cuttings & boundings as the above plat
 represents, Surveyed 11th June 1787,
 Recorded 25th April 1788, W. D. Thomas, Esq.

Carolina Pursuant to a warrant
 from John Thomas Com. of loc. 96 District
 of Saluda, dated 2^d Jan^y 1780, I have
 admeasured and laid out unto John
 Childers a tract of 660 acres of land
 in the District aforesd. Greenville County
 on branches of 3^d Tugger & 2 branches
 of Shishal Thomsons beaver-dam fork
 of Middle Tugger river, bounding
 by a line running on land survey
 for Culbertson & Company, A.S. by Thomas
 Thomas, N 49° 10' George Salmon N 53° 44' Hugh Rob^t Nelson
 Realey, N 50° 10' Robert Nelson, N 51° 50' John Morrison
 Maxwell, S 43° 30' vac^t land, and hath such shape
 Represents, Surveyed 4th Jan^y 1789, W. D. Thomas, Esq.
 Recorded 20th April 1788, Elaposed by Robert Nelson & Hugh Realey the same Day,

