

State of South Carolina

Pursuant to a warrant from John Thomas Esq. Commr. of Locations I have admeasured & laid out unto Cushman Edson a tract of 1839 acres of land situated in Ninety six District S. side Broad River on branch creek of big sandy run of both such form & marks as the above plat represents. Surv. the 17. Jan 1788.

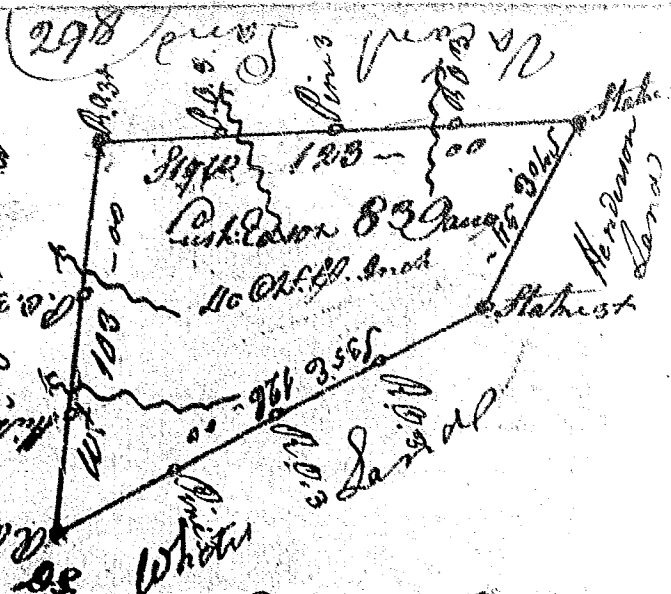

Recorded the 2nd Feb'y 1788. Sur. M. A. Thomson

S. Carolina 96 District,

Pursuant to a warrant from John Thomas Comr. of Locations, dated the 9th Dec. 1787. I have admeasured & laid out unto Jonathan Crow a tract of 146 acres of land in Spartanburg County, between the North & South forks of Tyger Rivers, bounded N. by the North fork, & N.W. Part on an old line & Part North quarter land S. by the S. forks of Tyger River, S.E. by James Crow's land, and hath such shape and marks as the above Plat represents

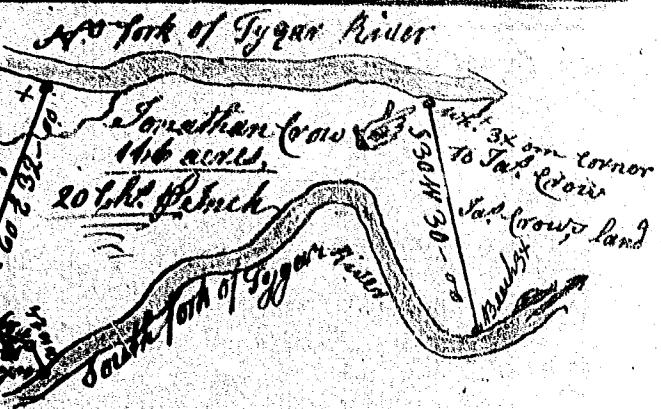

Recorded 4th febr'y 1788. Surveys 31. Dec. 1787 And. Thomson Esq.

State of S. Carolina 96 District, E. of the old boundary line

Pursuant to a warrant from John Thomas Comr. of Locations Dated 30th Nov. 1787. I have admeasured and laid out unto James Crow a tract of 124 acres of land, on the S. side of Tyger River, on a small branch of Jamesy Creek, bounded N. by Robert Rogers land, W. by John Lewis land, S. by Jacob Earnests land, E. by William Sloans land, all other sides Vacant Land & hath such shape, and marks as the above Plat represents. Surv. 3. Dec. 1787.

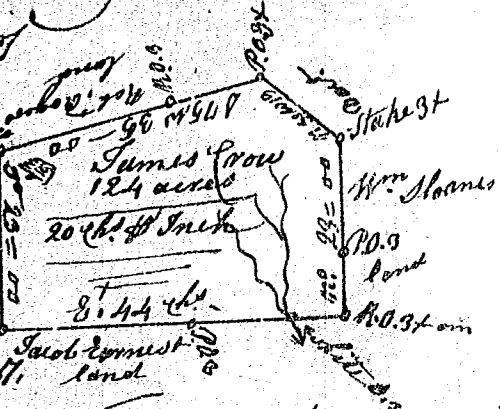

Recorded 4th febr'y 1788, — Anderson Thomson Esq.