

State of Carolina

(254)

Pursuant to a warrant
 from John Thomas Esq. Commiss^r
 of Location N. of Salisbury I have
 measured & laid out to
 Francis Lettmore a tract of
 427 acres of land - + 0.54
 Situate on both sides
 of ~~the~~ ^{the} ~~Trinity~~ ^{Trinity} Creek
 of Bernard's land
 Bounded S. W. by John
 Thomason's land S. E.
 by Stockton's land
 all other sides
 on west land + 0.07
 and hath the
 shape & marks as the
 above plat represents
 Certified the 1st Nov. 1787.

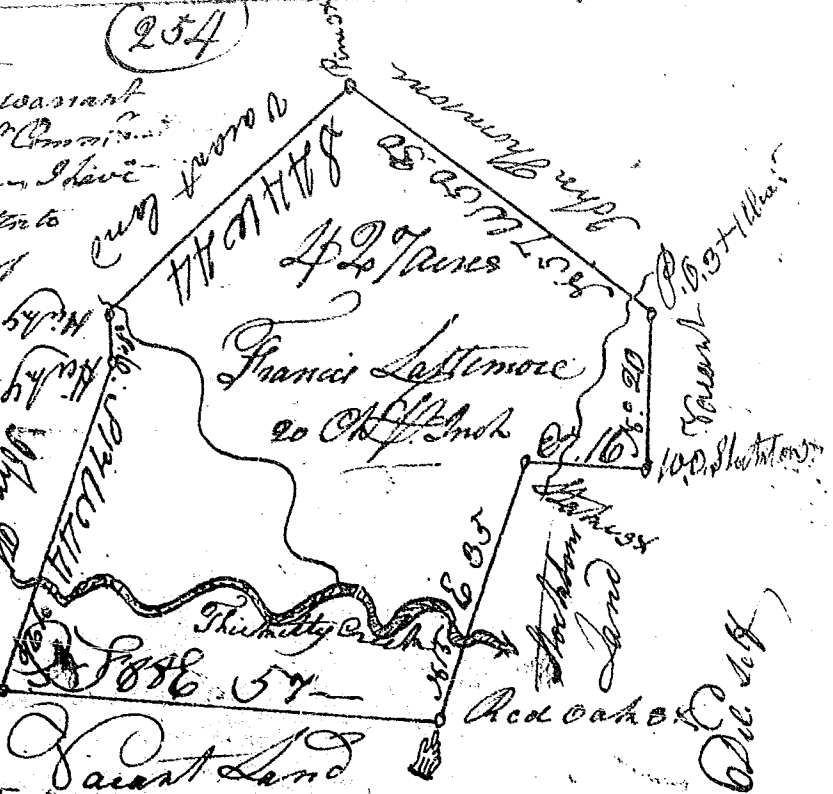

Recorded the 2nd Nov. 1787
 Dr. Cardozo M. Woods

Pursuant to a
 Warrant from J. Esq.
 Esq. Comm^r of Location
 in divided District
 North of Palmyra
 A tract of 300 acres
 of Land lying on the
 Head of Green Creek
 A branch of Pasquet River
 Bounded N. E. on Vacant Land
 North W. on Jones' Land S. W.
 Vac. Land S. E. David Smith's Land N. W. on Bulllock's
 Land N. E. on Bulllock's Land and such form & Marks
 As the above plat represents surveyed the 31st Oct
 1787
 Recorded the 2nd Nov 1787

