

Pursuant to a warrant from John Thomas Esq. C. L. dated the 21st July 1787. I have admeasured and laid out unto William Vaughan a tract of one hundred and four acres in the District of Sacoa River. Situate in the S. dis. on a branch of Guilford Creek waters of Sacoa River. Bounded N.W. by Berry Hill and Wm Collins all other sides vacant of both such shape from compass as the above plat represents.

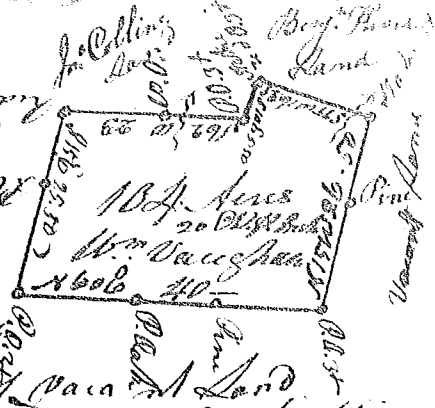

Surveyed the 15. Aug. 1787
 Recorded 8th October 1787
 Wm. Wofford Esq

State of S. Carolina Pursuant to a warrant from John Thomas Esq. C. L. dated the 21st March 1787. I have admeasured and laid out unto George Hains a tract of 126 acres of land. Situate in Greenville County. on a branch of South Tyger River. of both such form & marks Bittings & Boundings as the above plat represents.

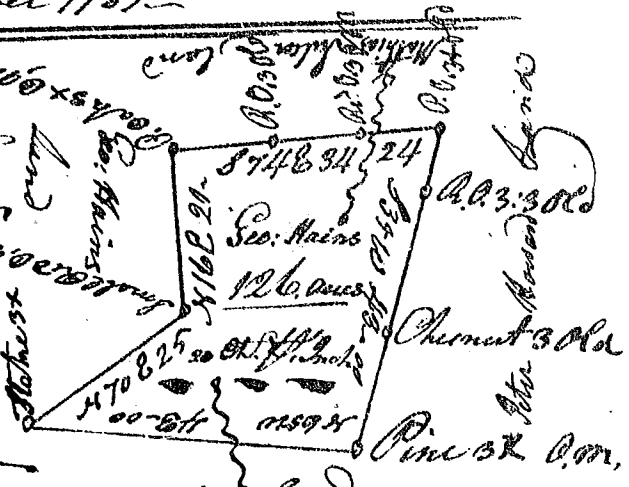

Recorded 16. Oct. 1787 Surveyed the 12. April 1787
 John Thomas Esq

S. Carolina Pursuant to a warrant from John Thomas Esq. C. L. in the District of Saco dated the 21st of August 1787. I have admeasured and laid out unto Merry M. Guire a tract of 62 1/2 acres of land. Situate in the S. dis. on the waters of Fannings Creek of the County formerly of Saco River. Bounding by a line running S.W. by lands Surveyed for Merry M. Guire B. N. W. & W. by lands Surveyed for Col. Chapman S.E. by land Surveyed for Gen. Wadingsman, all other sides vacant of unknown lands. of both such form & marks as the above plat represents.

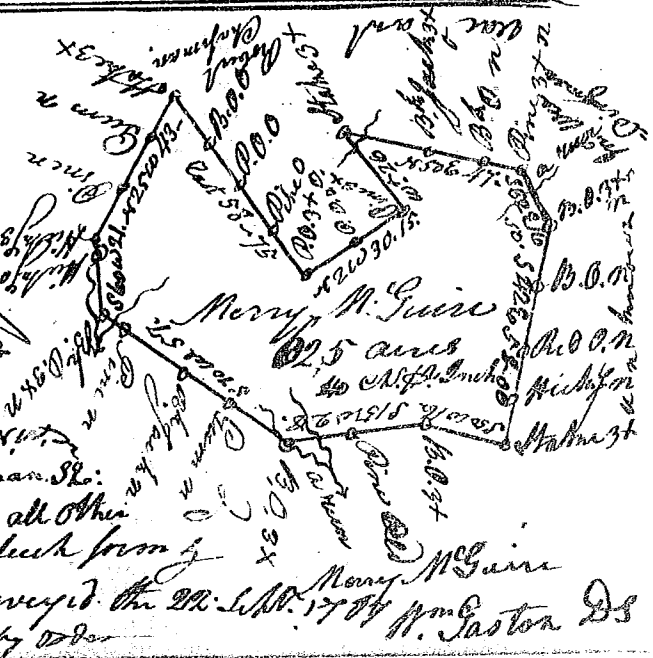

Surveyed the 22. Sept. 1787
 Recorded the 16. October 1787
 Wm. Saxon Esq