

State of S^c Carolina (243)

Pursuant to a warrant from John Thomas Esquire Commissioner of Locations Dated the 2^d of August 1787. I have admeasured and laid out unto Samuel Otterson a tract of Two Hundred acres of land. Situate in 96 District on branches of Tygar River south side of Broad River: and hath such shape and marks buttings and Boundings as the above plat represents.

Surveyed the 8th Aug. 1787

Recorded 4th Sept. 1787

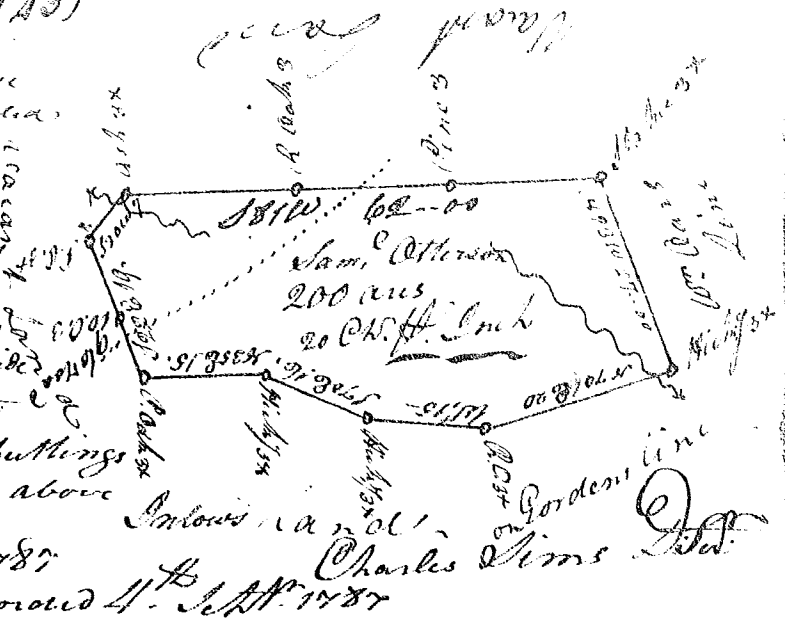

State of S^c Carolina. Pursuant to a warrant

from John Thomas Esquire Comm^r of Locations Dated the 25th March 1787. I have admeasured and laid out unto Robert Bailey a tract of One Hundred and forty nine acres of land. Situate in the District of ninety six on both sides of Ellis's fork of the Middle fork of Saluda River: and hath such shape and marks, buttings and Boundings as the above plat represents. Surv. 12th May 1787

Recorded 6th Sept. 1787

Surveyed by J. Whitmer

State of S^c Carolina. Pursuant to a warrant from

John Thomas Esq. Comm^r of Locations Dated the 21st March 1787. I have admeasured and laid out unto Robert Bailey a tract of seventy five acres of land. Situate in the District of 96, on both sides of Ellis's fork of the Middle fork of Saluda River: and hath such shape and marks, buttings and Boundings as the above plat represents.

Surveyed the 12th May 1787 by J. Whitmer

Recorded the 6th September 1787. Delivered the Owners

