

State of South Carolina 241  
 Pursuant to a warrant from John Thomas Esq. Commissioner of Locations Dated the 3<sup>rd</sup> Day of April 1787 I have Admeasured and laid out unto William Filippo a Tract of Two Hundred and Ninety Six acres of Land Situate in Greenville County in the For. of Saluda River on the Branch of the South & Middle forks of S. d. River and hath such Shape marks Buttings & Boundings as the above Plat represents, Surveyed the 5<sup>th</sup> day of April 1787 G. S. Salmon Del. Recorded 28<sup>th</sup> of Aug. 1787

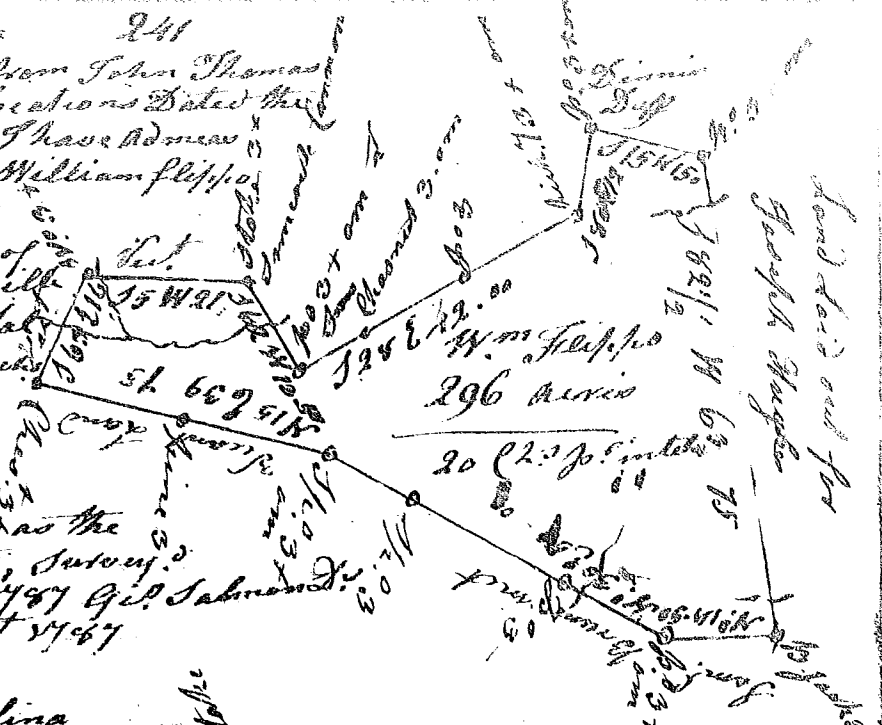

State of South Carolina  
 Pursuant to a warrant from John Thomas Esq. Commissioner of Locations Dated the 3<sup>rd</sup> day of April 1787 I have Admeasured and laid out unto William Filippo a Tract of one Hundred and Eighty Nine Acres of Land Situate in Ninety Six District, Greenville County on both Sides of how lands Branch of the South fork of Saluda River and hath such Shape Marks Buttings and Boundings as the above Plat represents, Surveyed the 5<sup>th</sup> day of April 1787 Recorded 28<sup>th</sup> of August 1787 Del. Self



State of S. Carolina  
 Pursuant to a warrant from John Thomas Esq. Commf. of Locations I have admeasured and laid out unto Thomas Duckett a tract of one Hundred and thirty acres of Land on a Small Branch of Enore River in Laurens County having such Shapes Marks Buttings and Boundings as the above plat represents, Surveyed the 13<sup>th</sup> Day of May 1787 Robert Hanna Del. Survey Recorded the 30<sup>th</sup> of August 1787

