

State of South Carolina / 9th District ²³⁷
 Pursuant to a warrant from John Thomas Esq^r Commissioner of locations & Saluda river I have admeasured and laid out unto David Vestal a tract of 220 acres of land, above the ancient boundary line on the waters of reedy river, bounded N.W. 1/4 on Wm. Waits land, N.E. 1/4 on Samuel Piles land, all other sides vacant land, and hath such shape, form & marks as the above Plat represents,
 Recorded 8th Aug^r 1787, Survey 20 June 1787 by James Seaborne Esq^r

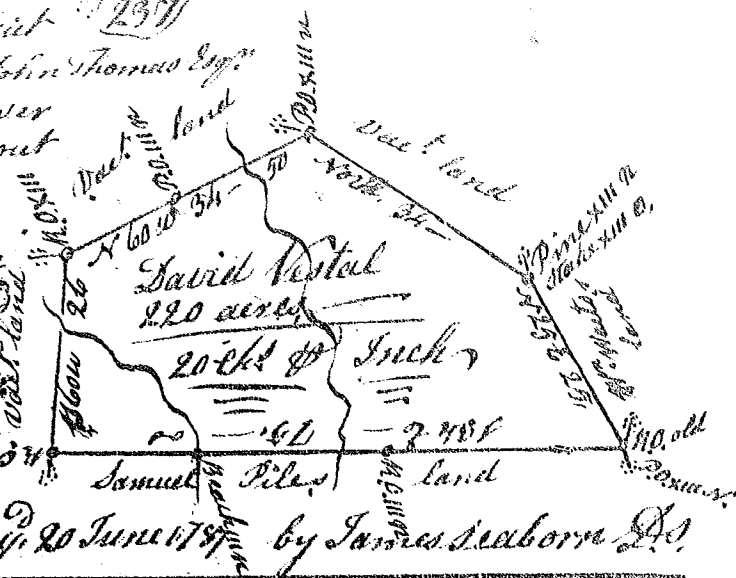

Pursuant to a warrant from John Thomas Esq^r Commissioner of locations, I have admeasured and laid out unto William Lipscomb a tract of fourteen acres of land on N. West fork of Hickety Creek on the blue branch, and hath such shape & marks as the above Plat represents,
 Survey 3rd Aug^r 1787, Recorded 6th Aug^r 1787, Lach^r Bullock Esq^r

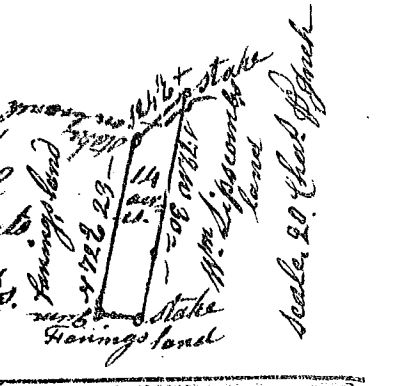

State of South Carolina / Pursuant to a Warrant from John Thomas Esq^r Commissioner of locations dated 30th April 1787, I have admeasured and laid out unto Thomas Tod a tract of seventeen acres of land on the south side of Tyger River including the river water with two small Islands, and hath such shapes, marks, Buttings & boundings as the above Plat represents,
 Recorded 9th Aug^r 1787, Survey 19 June 1787, Del^r John Hooker Esq^r J. W. Wofford Esq^r

