

State of South Carolina
 Pursuant to a warrant
 from John Thomas Esq. Comr.
 of locations, I have
 admeasured and laid out
 unto James

Montgomery a
 tract of four hundred
 and sixty six
 acres of land on
 Mountain Creek
 a branch of Saluda
 river, including part
 of the fork of Needy river
 call. the Needy fork, above
 the Indian boundary
 bounding N. on George
 Vaughan's land, S.E. part
 on Isaac Keltens land
 and part vacant land, all
 other sides on vacant
 land. Marks as the above
 Plat represents. Survey
 Recorded 4th Decr 1786,
 Robt Hanna Del

James Montgomery, 466 acres
 by a scale of 20 (1/2) Inch

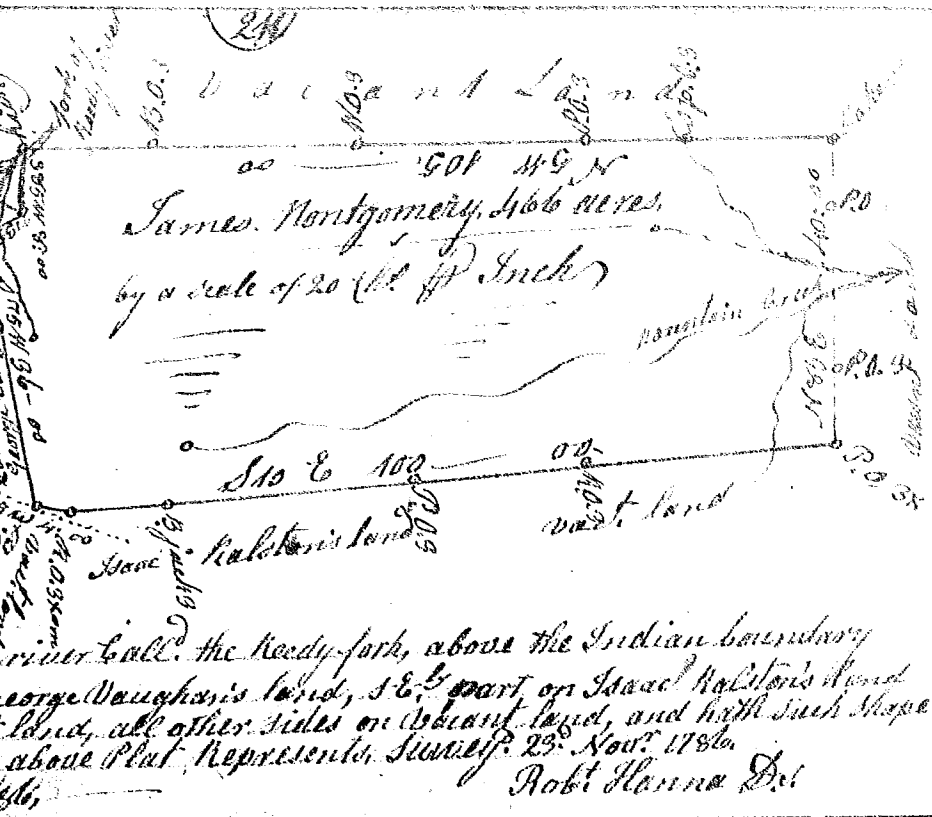

State of S^c Carolina.
 Pursuant to a warrant from
 John Thomas Esq. Comr. of locations
 Dated 29th Jan'y 1787,
 I have admeasured and laid
 out unto William Tubbs a tract
 of one hundred and seventy
 acres of land, in Greenville
 County on both sides of
 the long branch of S^c Tiger
 River, and hath such shape &
 Marks as the above Plat represents.
 Survey 12th April 1787.
 Recorded 15th May 1787,
 Wm D. Thomas, D. S.

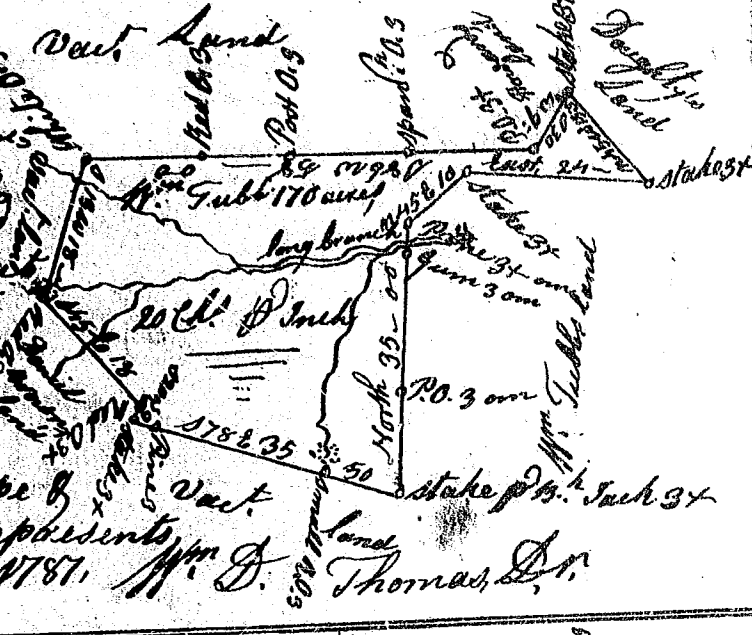

State of S^c Carolina Pursuant to a warrant
 from John Thomas Comr. of locations, I have
 admeasured and laid out unto Joseph
 Martindele a tract of 139 acres of land, on
 a small branch of Enoree river in Laurens
 County, having such shape marks
 buttins and boundings as the above
 Plat represents. Surv. 15th March 1787
 Recorded 15th May 1787
 Robt Hanna Del
 Delm Arch Kennedy

