

State of S^c Carolina Pursuant to a warrant from John Thomas Esq. Com^r of locations at Saluda, Dated 20th Sept. 1786 I have admeasured and laid out unto James Chesten a tract of one hundred and fifty four acres of land, in 96 district on the Needy fork creek of S^c Sugar river, and hath such shape and Marks, buttines & boundaries as the above Plat represents Survey^d 21st Sept^r 1786. Recorded 30th Jan^y 1787.

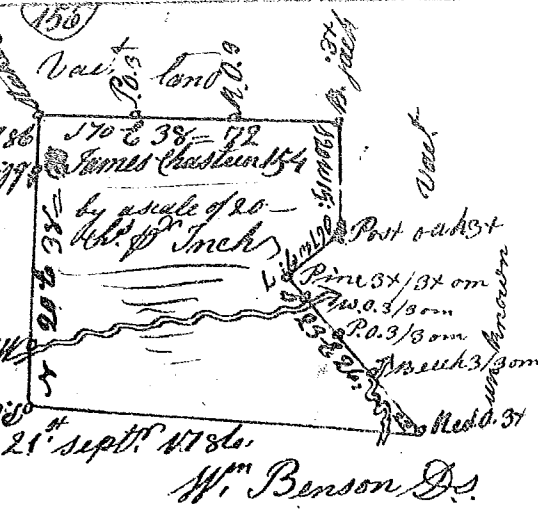

State of S^c Carolina, Pursuant to a warrant from John Thomas Com^r of locations Dated 19th Nov^r 1786, I have admeasured and laid out unto Richard Collins a tract of four hundred & sixty nine acres of land on both sides of Gilders Creek, including the Place known by the name of the three forks of said Creek Bounded on all sides by Vacant Land, and hath such shape and Marks as the above Plat represents, Survey^d 22nd Nov^r 1786. Recorded 30th Jan^y 1787.



State of S^c Carolina, Pursuant to a warrant from John Thomas Esq. Com^r of locations Dated 15th Jan^y 1787, I have admeasured and laid out unto James Peck a tract of one hundred and twelve acres of land, on the Needy fork of Gilders Creek W. of Enored river, Bounded Sth by Henry Huff's land, all other sides on Vac. Land, and hath such form and Marks as the above Plat represents, Survey^d 14th Jan^y 1787. Recorded 31st Jan^y 1787.

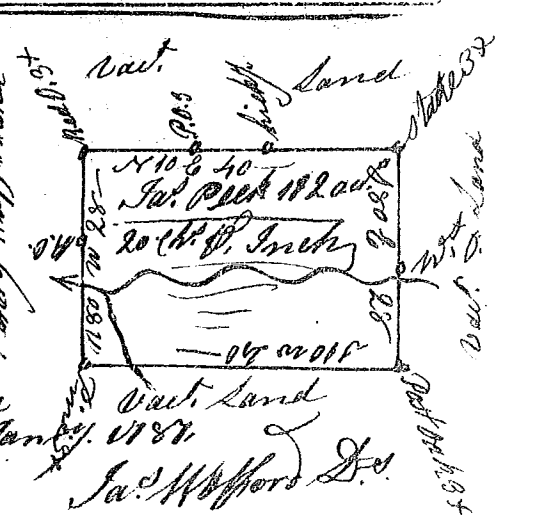

Del. self