

State of S<sup>c</sup> Carolina

(111)

Pursuant to a warrant from John Thomas Esq. Comm<sup>r</sup> of Locations Dated the 19<sup>th</sup> Aug. 1786. I have Admeasured & laid out unto Samuel James Alston, a tract of Seventy four Acres of Land Situate in 96 District Above the 3<sup>d</sup> boundary on branches of Reddy River. Adjoining Rich. Paris's 3<sup>d</sup> Plantation

with such other marks, Buttings & Boundings as the above Part<sup>r</sup> Represents. Surveyed the 19<sup>th</sup> Aug. 1786.  
Recorded 16<sup>th</sup> Jan<sup>y</sup> 1787 D. W. Whitner

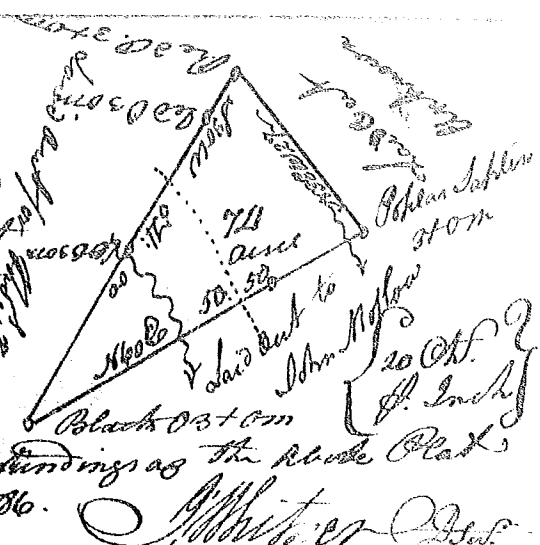

S<sup>c</sup> Carolina

Pursuant to a warrant from John Thomas Esq. Comm<sup>r</sup> of Locations Dated the 24<sup>th</sup> Oct. 1786. I have Admeasured & laid out unto Samuel James Alston a tract of 521 Acres of Land Situate in the District of 96 in Greenville County. on both sides of the fork of Rich land emb<sup>d</sup> of Reddy River & hath such other marks, Buttings & Boundings as the above Part<sup>r</sup> Represents.



Surveyed the 1<sup>st</sup> of Jan<sup>y</sup> 1787  
Recorded 16<sup>th</sup> Jan<sup>y</sup> 1787  
15

Warrant La 1786  
Surveyed the 1<sup>st</sup> of Jan<sup>y</sup> 1787

Whitner Surveyor

Delivered W. Whitner