

State of S. Carolina

Pursuant to a warrant from John Thomas Esq. Comr. of locations dated 10th Nov. 1786. I have admeasured and laid out unto Moses Purviance a tract of one hundred & forty seven acres of land, on a small branch of Dutchmans Creek, on south side of said Creek, & branches of Tyger river, and hath such shape, Marks, and form as the above Plat represents, Survey. 13th Nov. 1786. Andrew Thomson Esq. Recorded 28th Dec. 1786, Del. C. Hanna

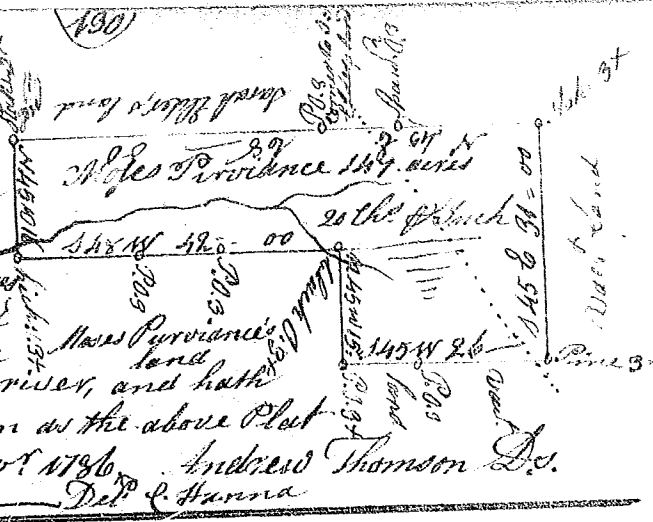

State of South Carolina

Pursuant to a warrant from John Thomas Esq. Comr. of locations dated 26th Dec. 1786. I have admeasured and laid out unto William Ramplly a tract of one hundred and Twenty Two acres of land in Spartenburg County, on the N^o Side of Tyger river, on both sides of Cain Creek, and hath such form shape and Marks as the above Plat represents, Survey. 27th Dec. 1786. Andrew Thomson Esq. Recorded 28th Dec. 1786, Del. C. Hanna

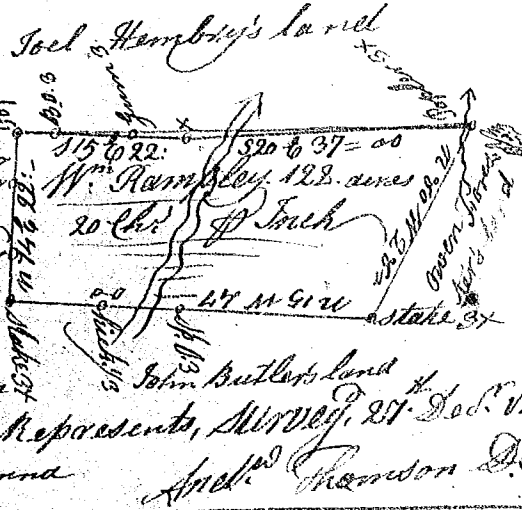

State of South Carolina

Pursuant to a warrant from John Thomas Esq. Comr. of locations Dated the 11th Dec. 1786. I have admeasured and laid out unto Ephraim Hill a tract of Three hundred & Nineteen acres of land, in Spartenburg County, on the small branches of Dutchmans Creek & outers of Tyger river, and hath such shape & Marks as the above Plat represents, Survey. 26th Dec. 1786. Andrew Thomson Esq. Recorded 28th Dec. 1786, Del. C. Hanna

